

Wind Europe 2025

# Danish Energy Export



**Danish ENERGY**  
**Export** Owned by  
Danish Export Association  
and Green Power Denmark

# Table of Contents

Cover	1
Table of Contents	2
3D View 1	3
3D View 2	4
3D View 3	5
3D View 4	6
3D View 5	7
3D View 6	8
Floor Plan	9
Floor Plan	10
Find your graphics dimensions	11
Graphics dimensions - section 1	12
Graphics dimensions - section 2	13
Graphics dimensions - section 3	14
Graphics dimensions - section 4	15
Graphics dimensions - section 5	16
Graphics dimensions - section 6	17
Graphics dimensions - section 7	18
Graphics dimensions - section 8	19
Graphics dimensions - section 9	20
Info	21



# 3D View 1

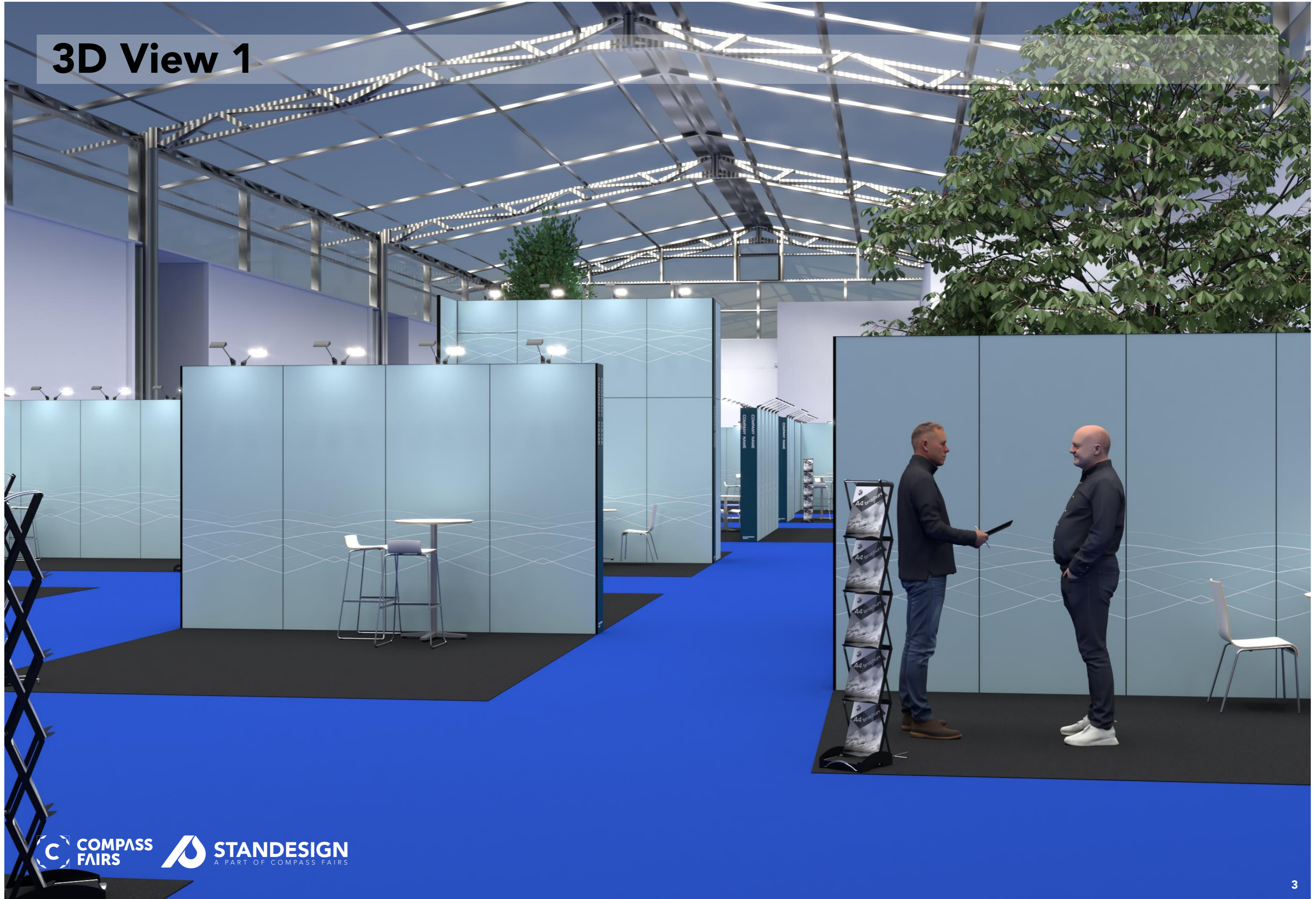



# 3D View 2





# 3D View 3





# 3D View 4





# 3D View 5





# 3D View 6





# Floor Plan

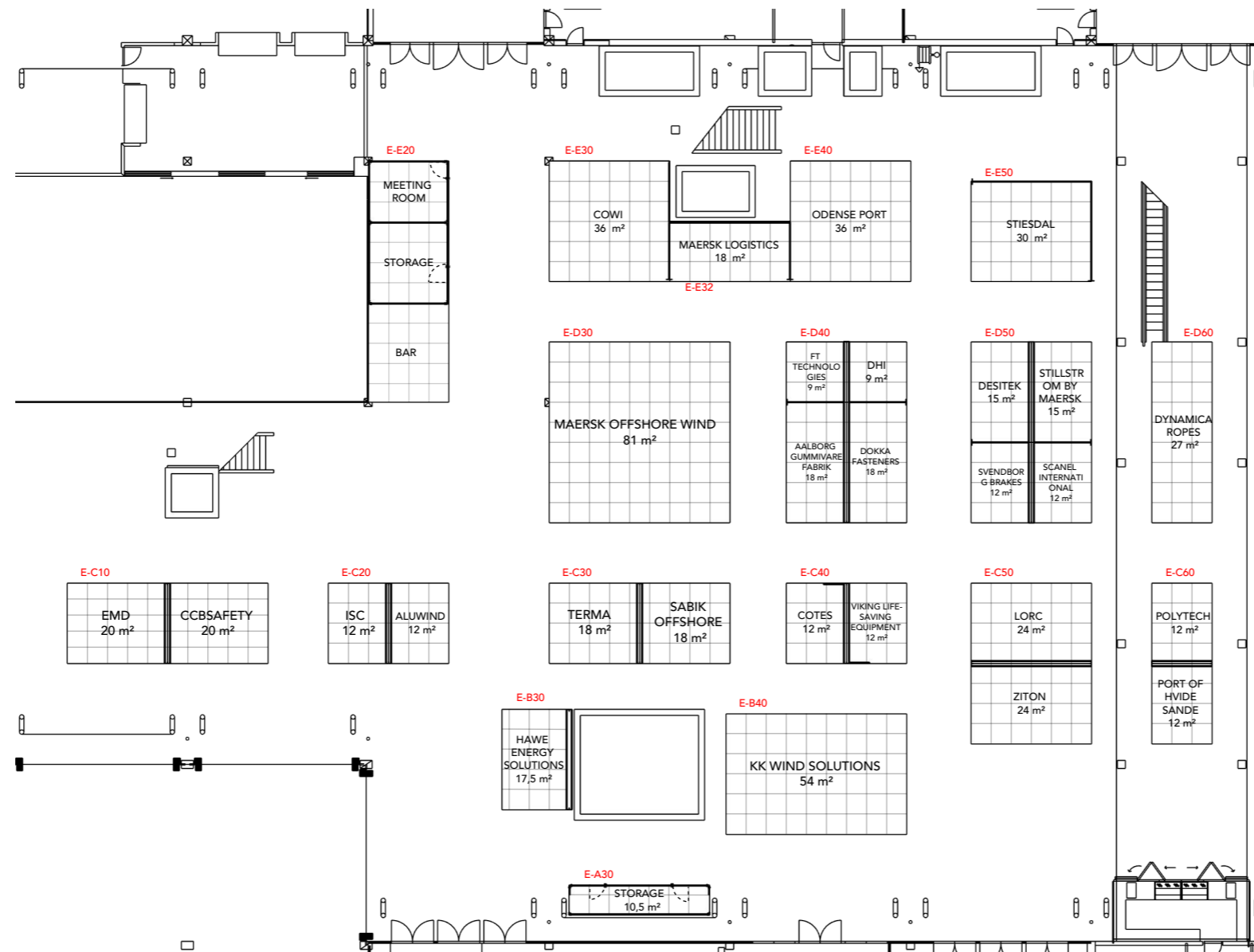

PORT OF HVIDE SANDE:  
HVIDE SANDE SERVICE GROUP



# Floor Plan

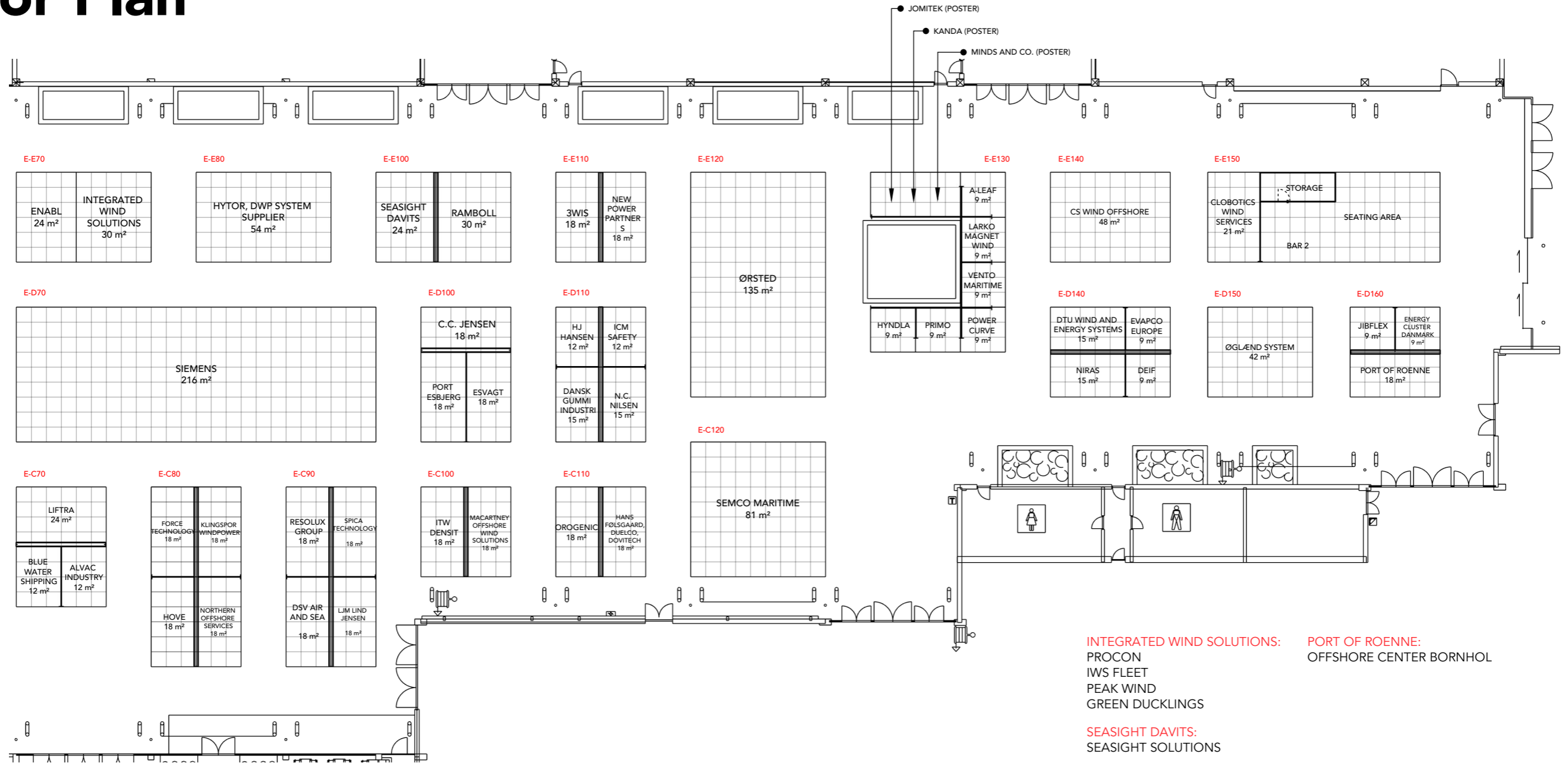

- INTEGRATED WIND SOLUTIONS:**  
 PROCON  
 IWS FLEET  
 PEAK WIND  
 GREEN DUCKLINGS
- SEASIGHT DAVITS:**  
 SEASIGHT SOLUTIONS
- RESOLUX GROUP:**  
 GEXPRO SERVICES  
 FRONTIER TECHNOLOGIES
- HYTOR:**  
 TS TECH
- DWP SYSTEM SUPPLIER:**  
 CNC ONSITE A/S  
 NORSEA DENMARK A/S  
 PORT OF GRENA  
 THORSMINDE HAVN  
 NICON INDUSTRIES A/S  
 BRING CARGO INTERNATIONAL A/S
- PORT OF ROENNE:**  
 OFFSHORE CENTER BORNHOL



# Find your graphics dimensions

## Page 12

ALUWIND  
CCBSAFETY  
EMD  
HAWE ENERGY SOLUTIONS  
ISC  
SABIK OFFSHORE  
STORAGE  
TERMA

## Page 14

DESITEK  
SCANEL INTERNATIONAL  
STIESDAL  
STILLSTROM BY MAERSK  
SVENDBORG BRAKES

## Page 16

ALVAC INDUSTRY  
BLUE WATER SHIPPING  
DSV AIR AND SEA  
FORCE TECHNOLOGY  
HOVE  
KLINGSPOR WINDPOWER  
LIFTRA  
LJM LIND JENSEN  
NORTHERN OFFSHORE SERVICES  
RESOLUX GROUP  
SPICA TECHNOLOGY

## Page 18

3WIS  
C.C. JENSEN  
DANSK GUMMI INDUSTRI  
ESVAGT  
HJ HANSEN  
ICM SAFETY  
N.C. NIELSEN  
NEW POWER PARTNERS  
PORT ESBJERG  
RAMBOLL  
SEASIGHT DAVITS

## Page 20

CLOBOTICS WIND SERVICES  
ENERGY CLUSTER DANMARK  
JIBFLEX  
PORT OF ROENNE  
STORAGE

## Page 13

AALBORG GUMMIVARE FABRIK  
COWI  
DHI  
DOKKA FASTENERS  
FT TECHNOLOGIES  
MAERSK LOGISTICS  
ODENSE PORT  
STORAGE

## Page 15

COTES  
LORC  
POLYTECH  
PORT OF HVIDE SANDE  
VIKING LIFESAVING EQUIPMENT  
ZITON

## Page 17

HANS FØLSGAARD, DUELCO, DOVITEC  
ITW DENSIT  
MACARTNEY OFFSHORE WIND SOLUTIONS  
OROGENIC

## Page 19

A-LEAF  
DEIF  
DTU WIND AND ENERGY SYSTEMS  
EVAPCO EUROPE  
HYNDLA  
JOMITEK (P)  
KANDA (P)  
LARKO MAGNET WIND  
MINDS AND CO. (P)  
NIRAS  
POWER CURVE  
PRIMO  
VENTO MARITIME



# Graphics dimensions - section 5

WALL HEIGHT: 2480mm

- Full size Fabric
- Single Frame Fabric

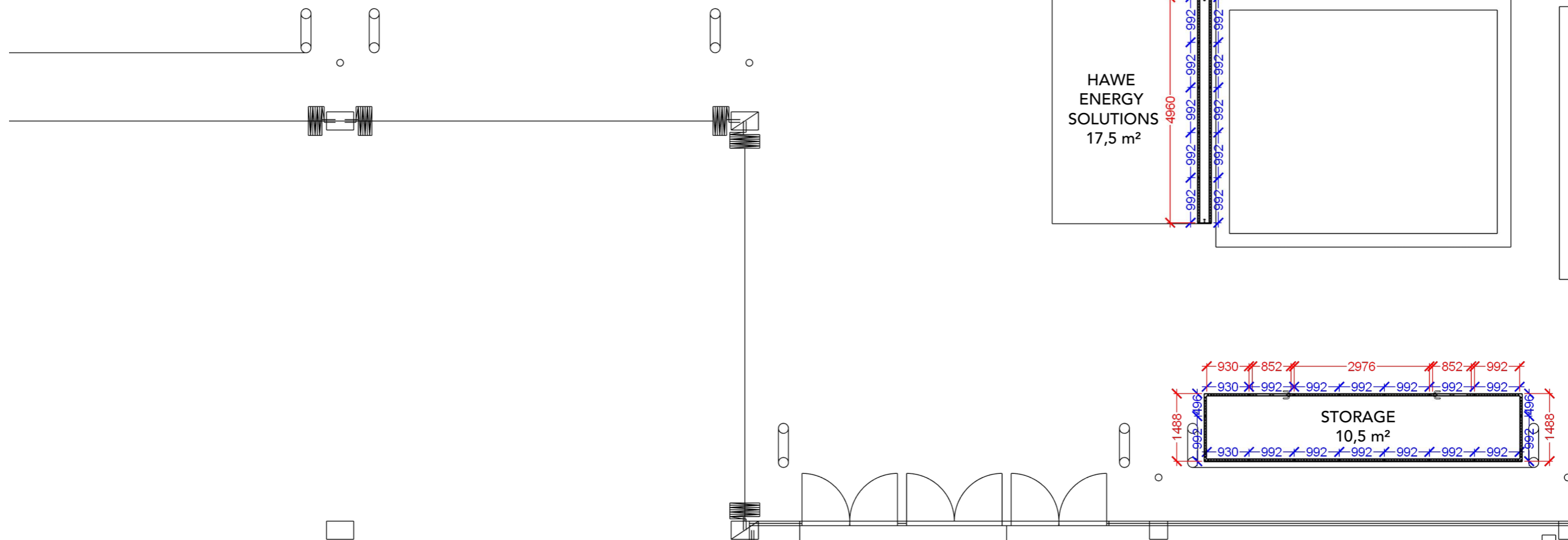
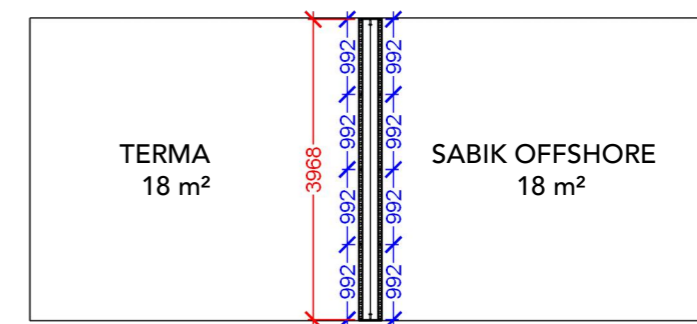
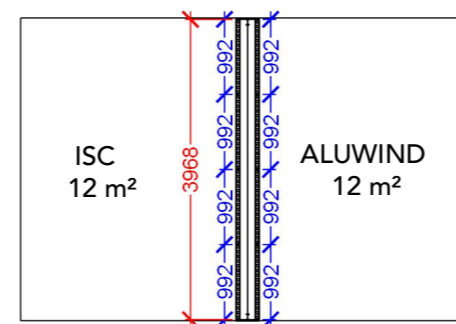
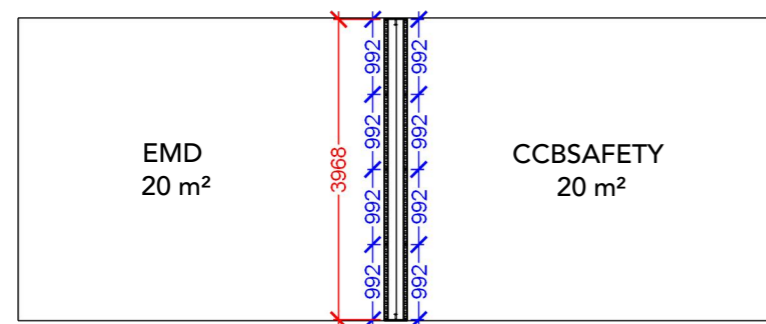

# Graphics dimensions - section 2

WALL HEIGHT: 2480mm

- Full size Fabric
- Single Frame Fabric

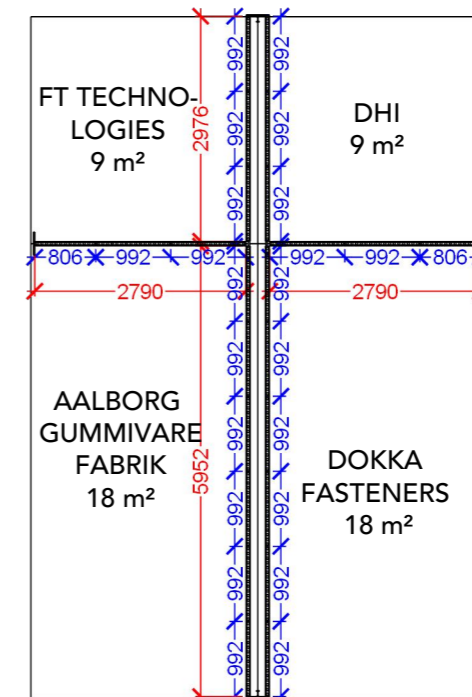
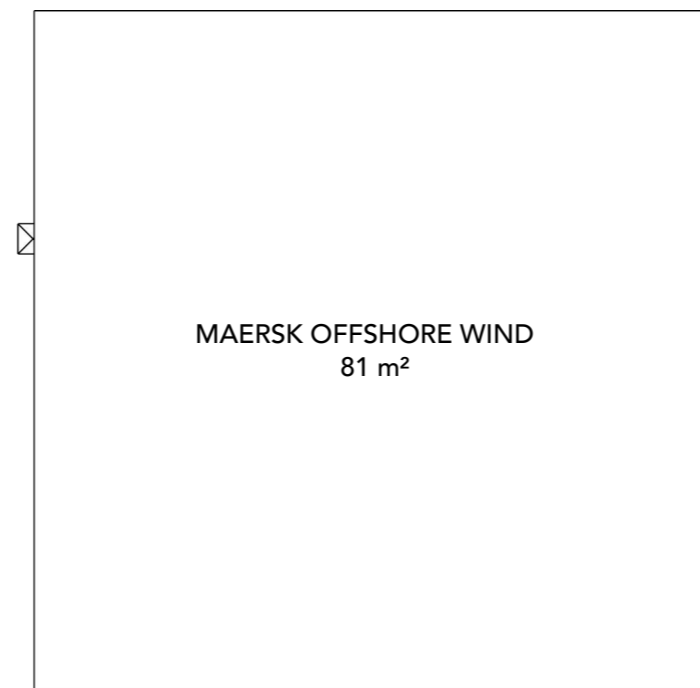
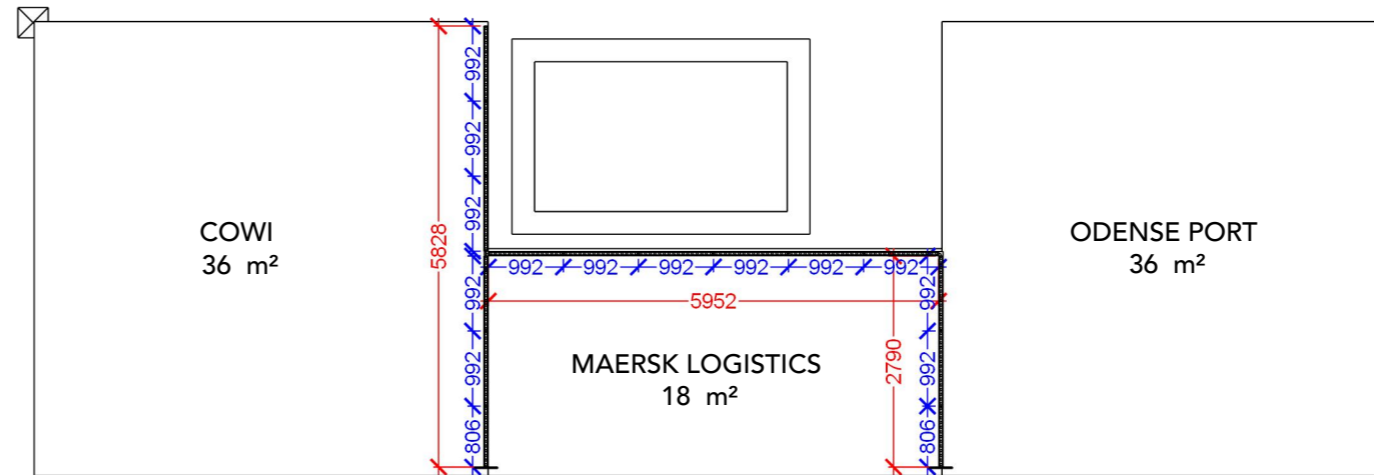
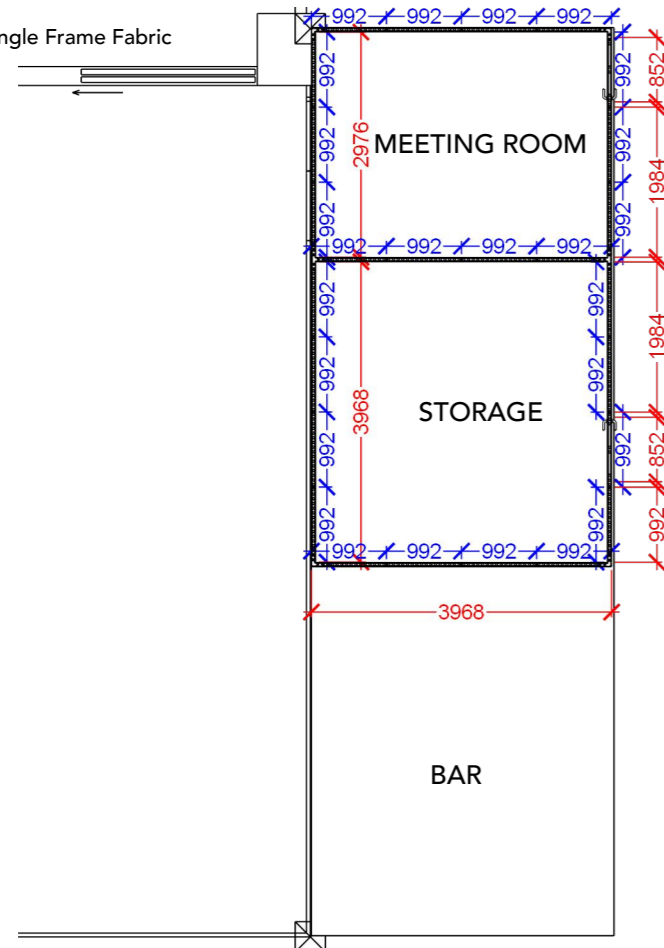



# Graphics dimensions - section 3

WALL HEIGHT: 2480mm

- Full size Fabric
- Single Frame Fabric

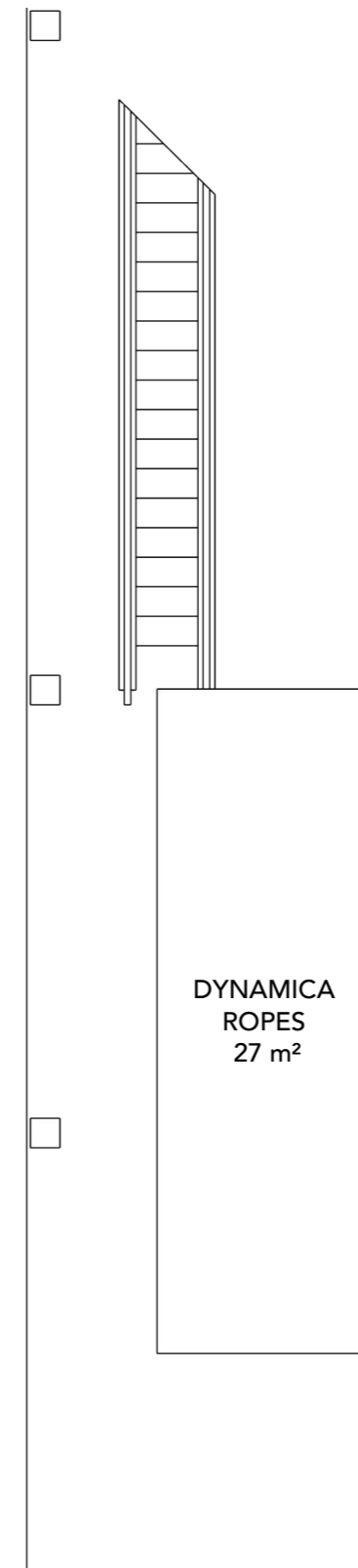
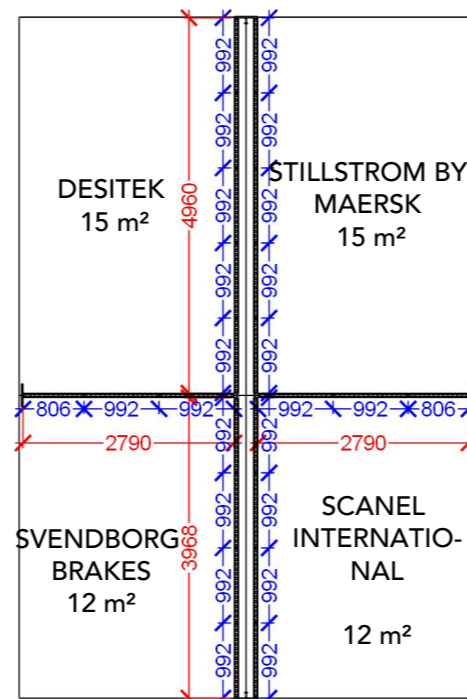
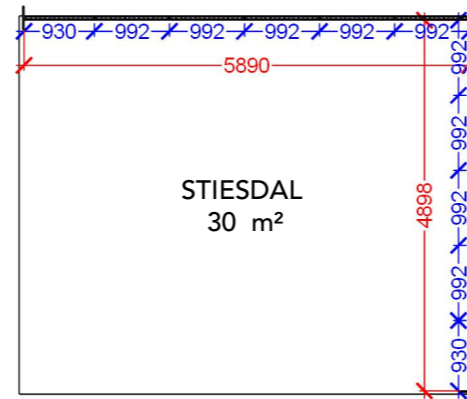

# Graphics dimensions - section 4

WALL HEIGHT: 2480mm

- Full size Fabric
- Single Frame Fabric

• OBS: 2 DIFFERENT HEIGHT SIZES

Backwall Bottom: 3906x2480mm  
Backwall Top: 3906x1488mm

Sidewall Bottom: 992x2480mm  
Sidewall Top: 992x1488mm

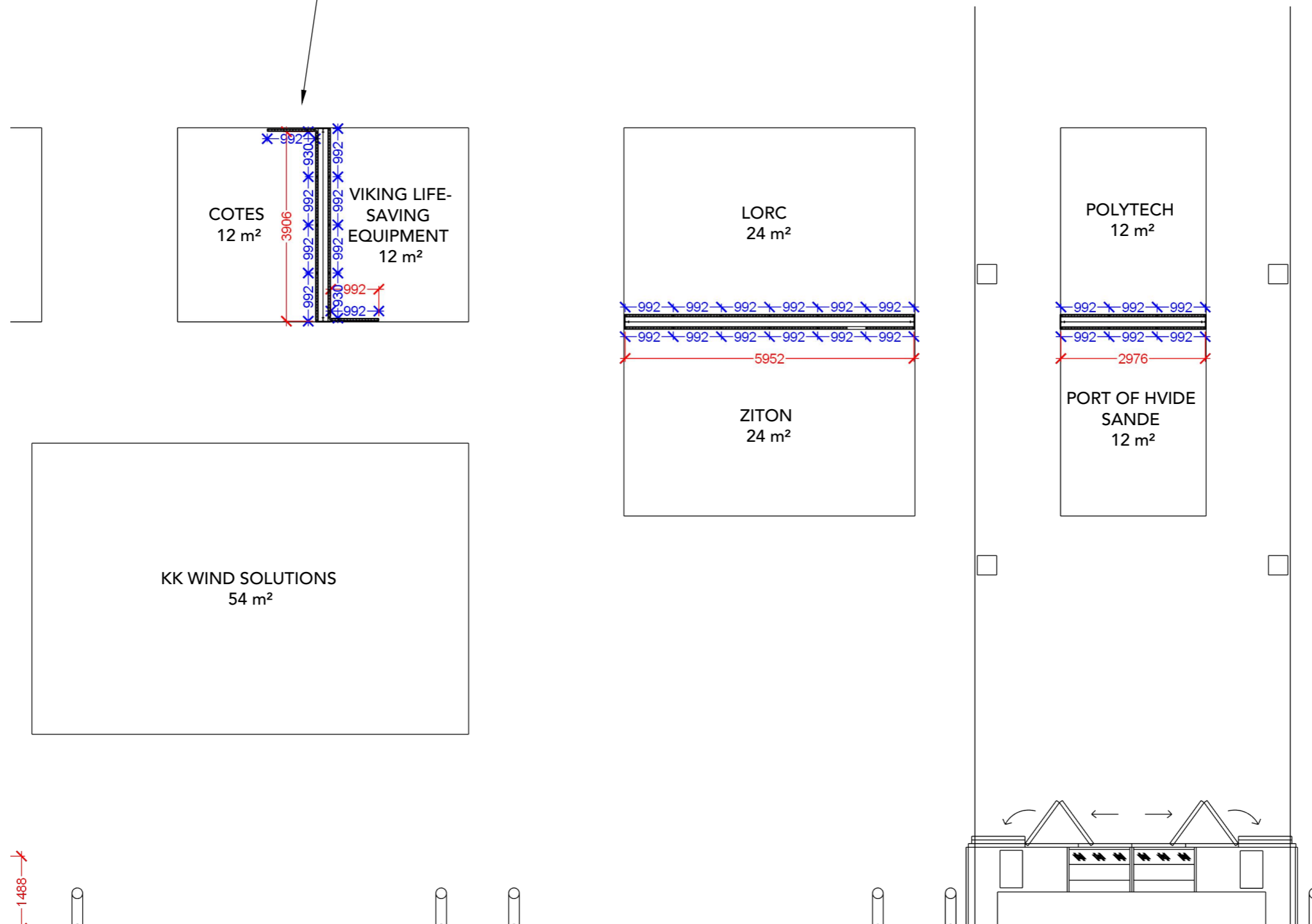



# Graphics dimensions - section 5

WALL HEIGHT: 2480mm

- Full size Fabric
- Single Frame Fabric

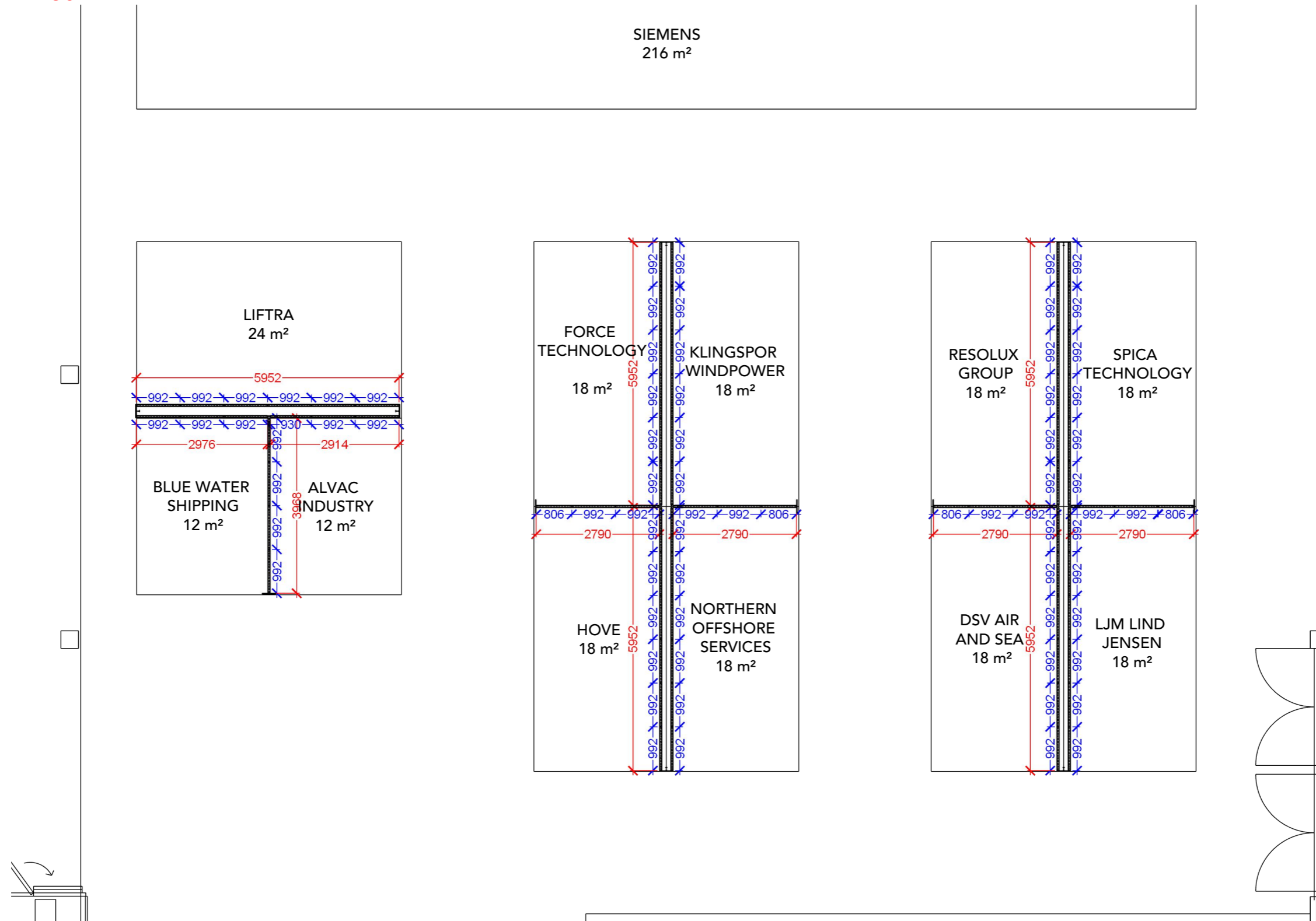

# Graphics dimensions - section 6

WALL HEIGHT: 2480mm

- Full size Fabric
- Single Frame Fabric

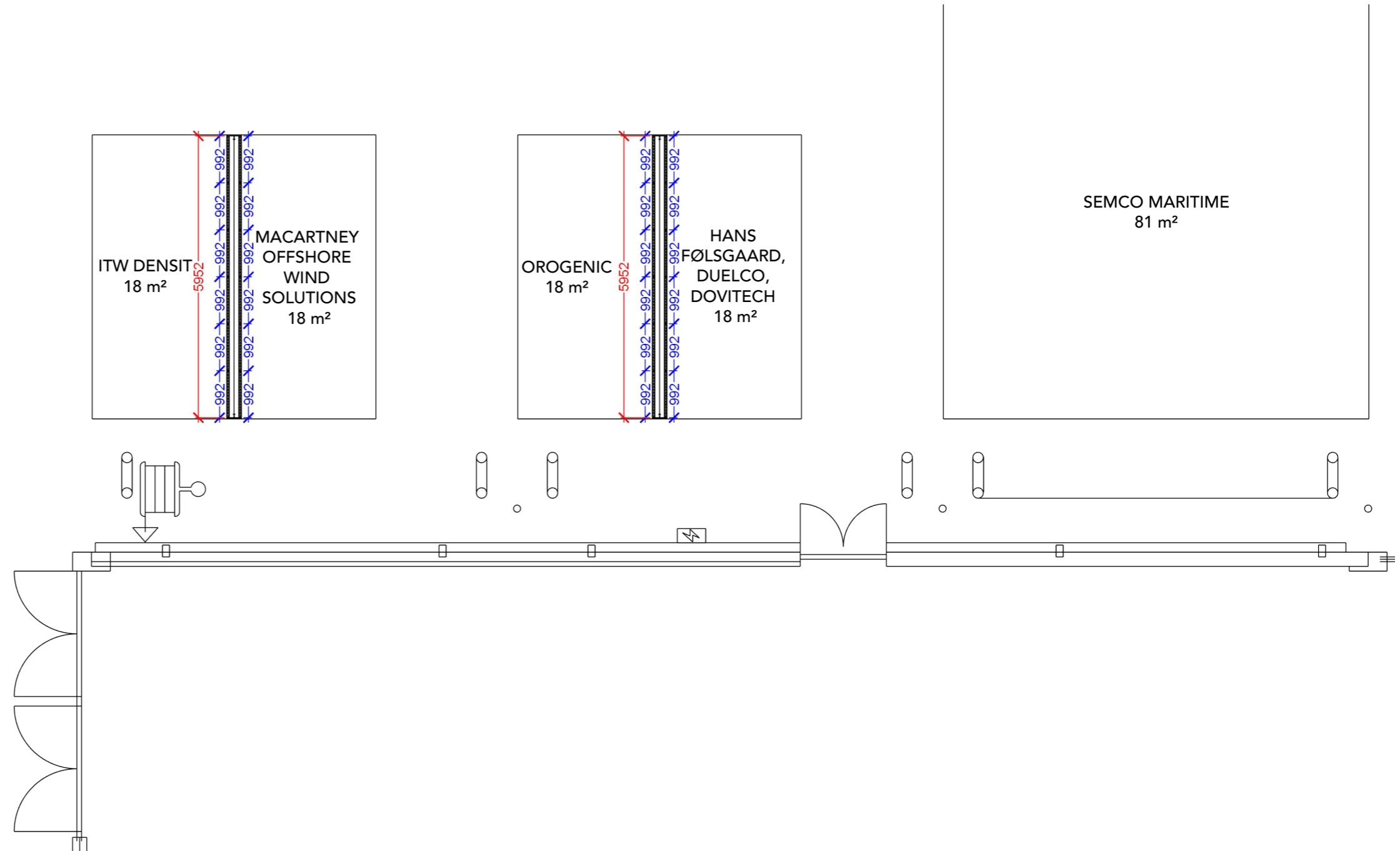



# Graphics dimensions - section 7

WALL HEIGHT: 2480mm

- Full size Fabric
- Single Frame Fabric

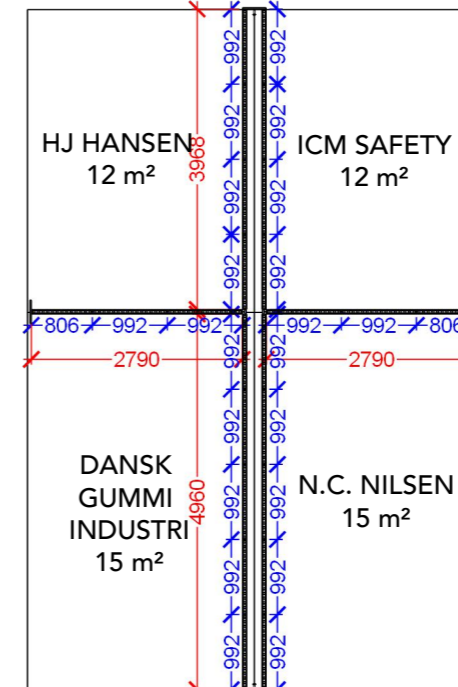
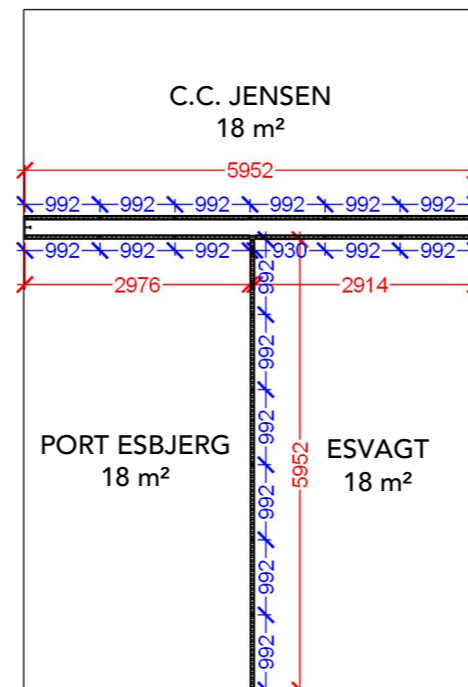
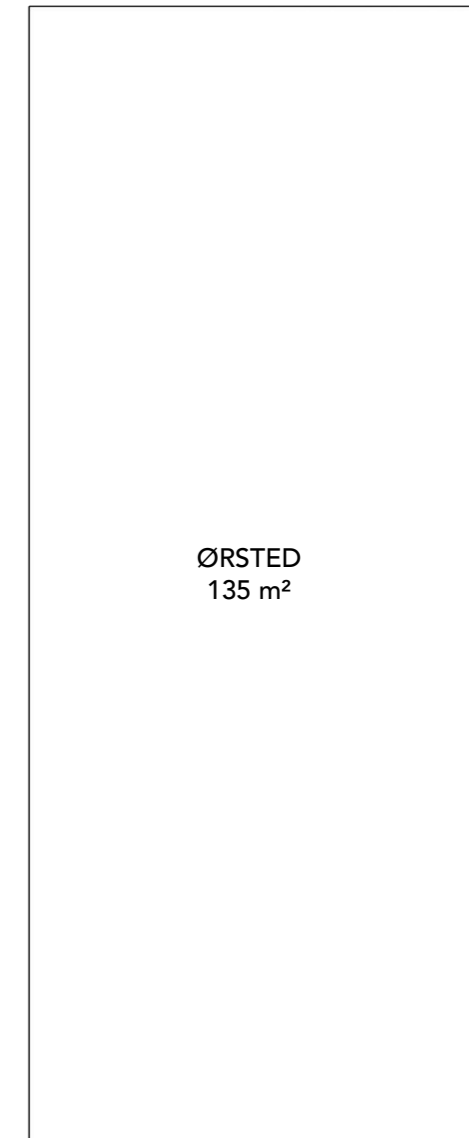
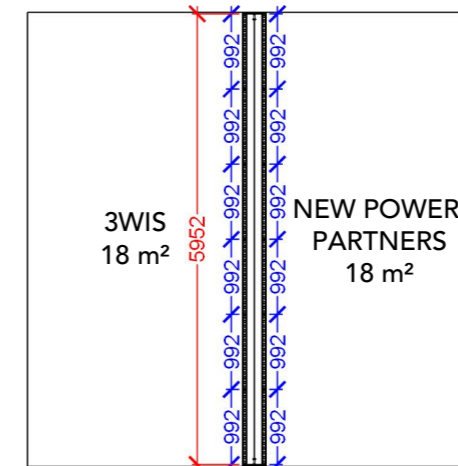
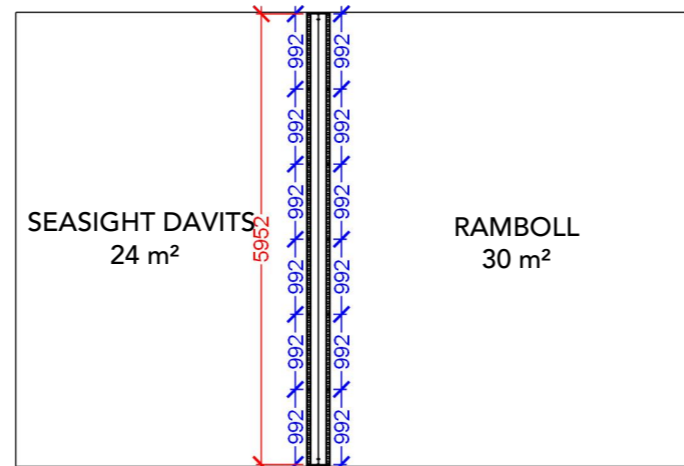

# Graphics dimensions - section 8

WALL HEIGHT: 2480mm

- Full size Fabric
- Single Frame Fabric

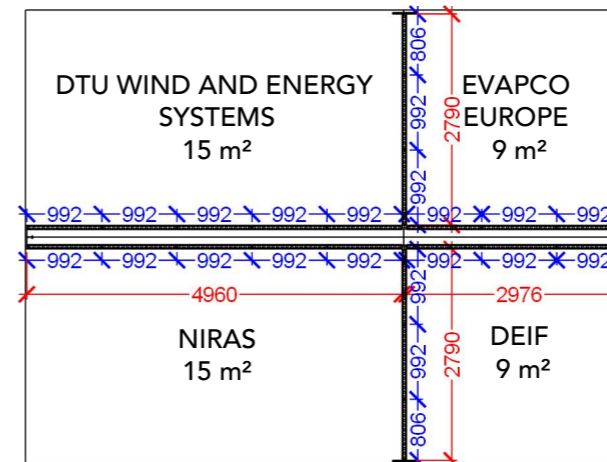
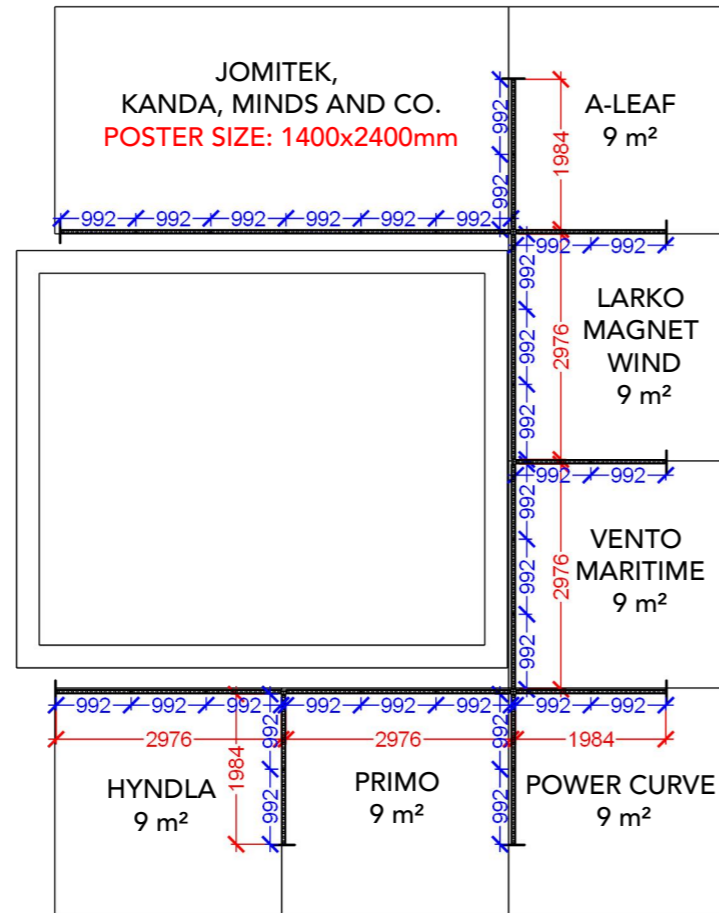



# Graphics dimensions - section 9

WALL HEIGHT: 2480mm

- Full size Fabric
- Single Frame Fabric

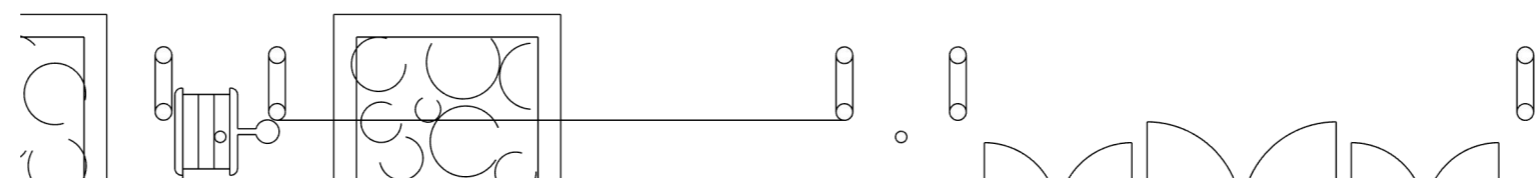
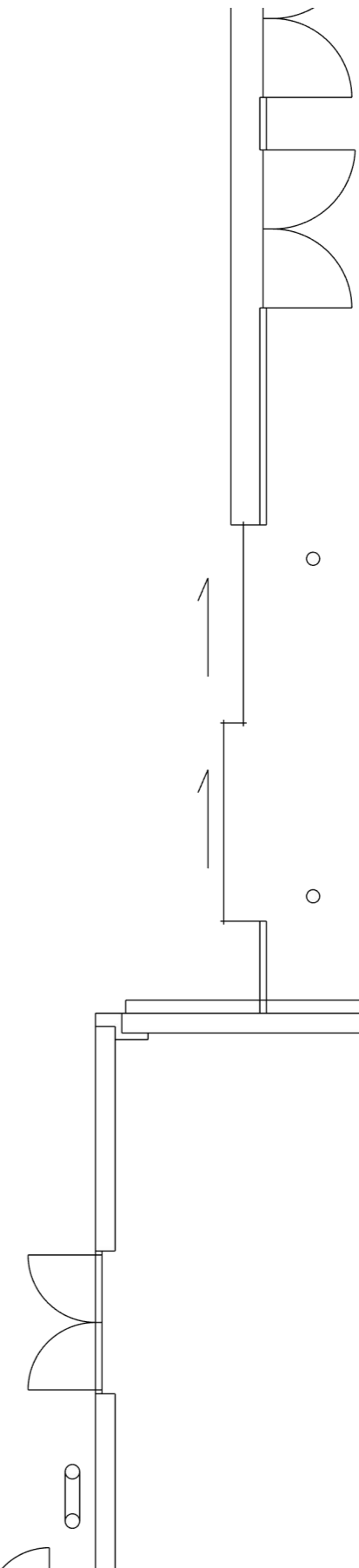
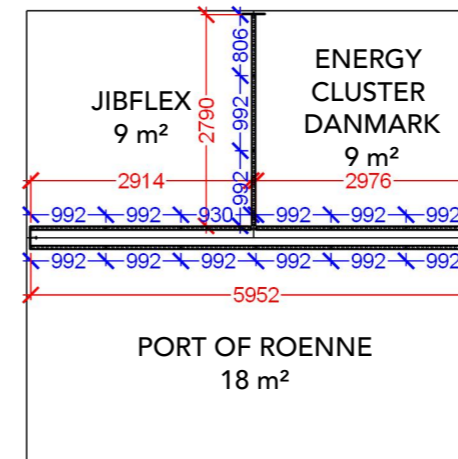
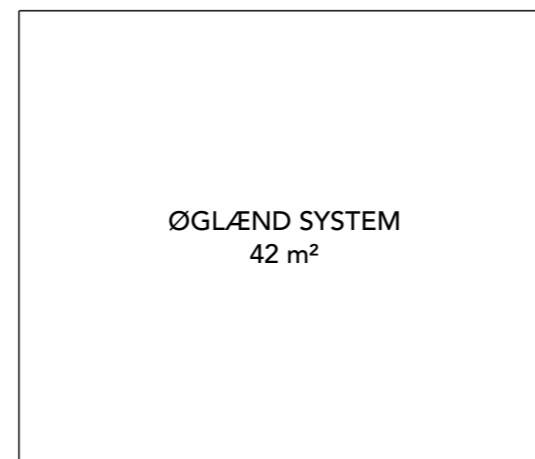
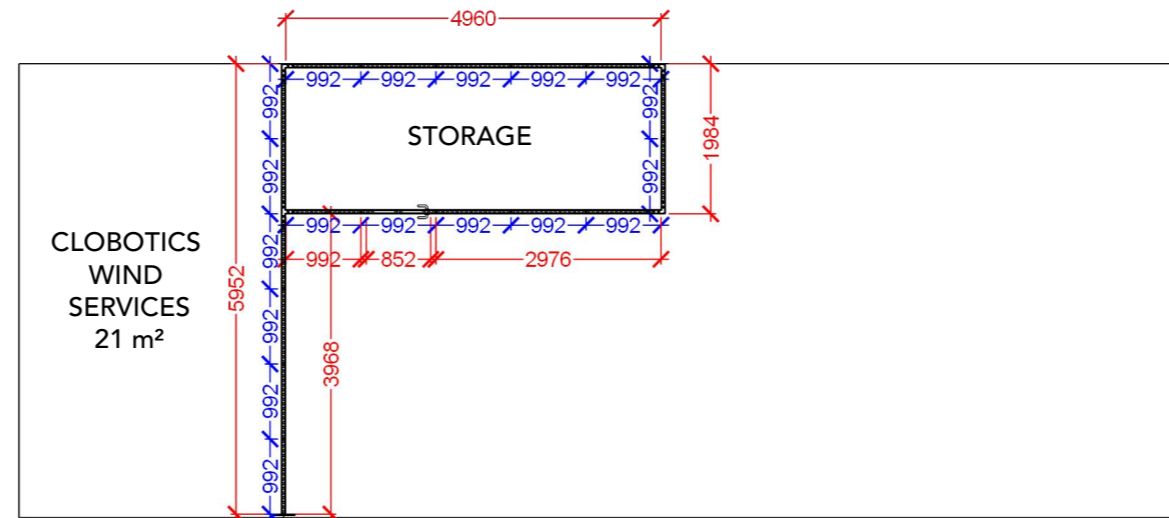

# Info

Client: Danish Energy Export  
Exhibition: Wind Europe 2025

Project no.: EXP-WEU-25-04  
Designed By: SMM / THJ  
Hall: E  
Booth: Multiple

Creation Date: 13.11.2024  
Revision Date: 14.01.2025  
Revision no.: 06

Comments:

The drawing is indicative and without responsibility. The drawing is NOT to scale. The stand-builder will have the final call in all decisions regarding stability and security. Some products are only shown to indicate locations, but not the actual product as this product may be changed.  
All design is subject to copyright by Compass Fairs A/S and Standesign A/S

