

Wind Europe 2025

Danish Energy Export

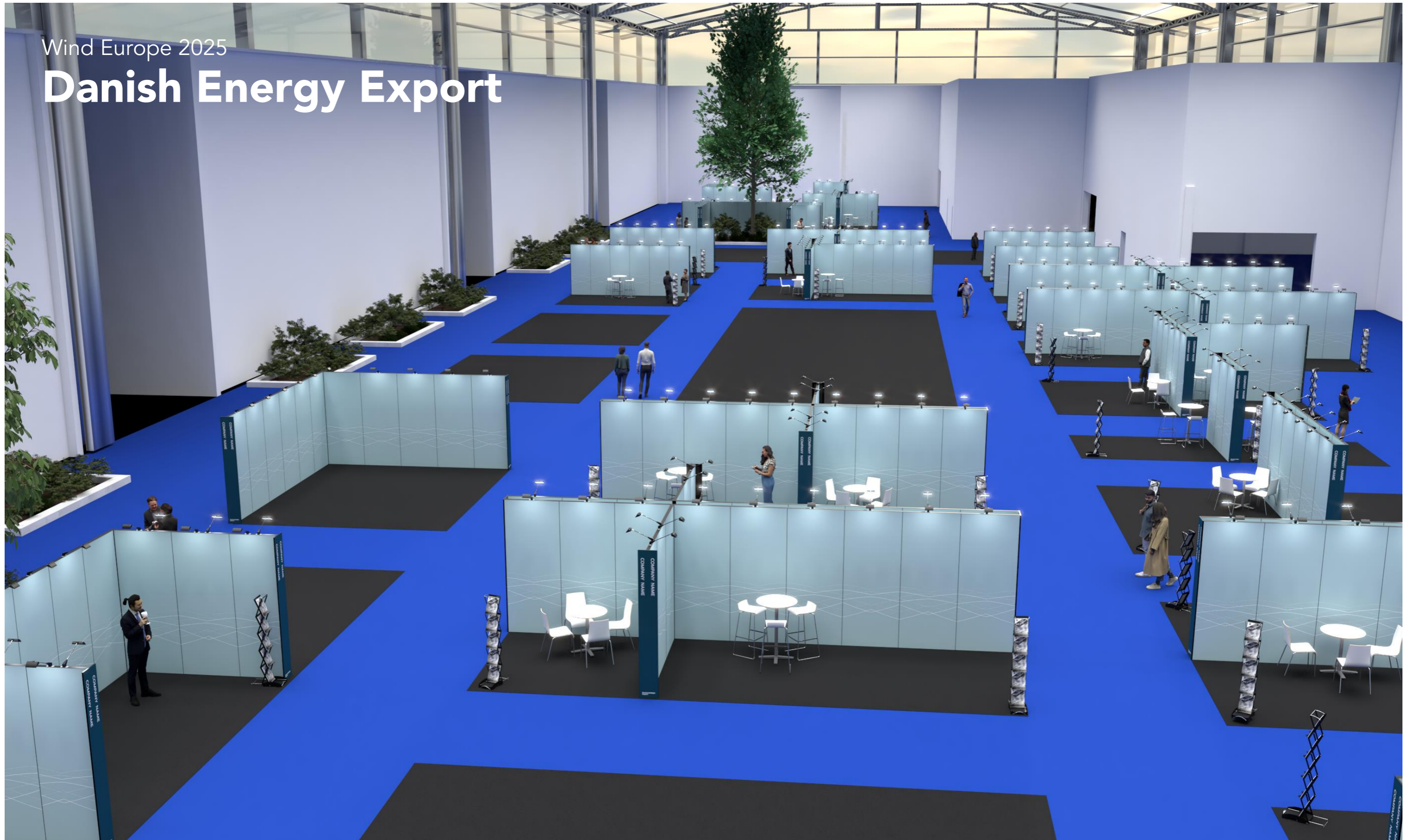

Danish ENERGY Export
Owned by Danish Export Association and Green Power Denmark

Table of Contents

Cover	1
Table of Contents	2
3D View 1	3
3D View 2	4
3D View 3	5
3D View 4	6
3D View 5	7
3D View 6	8
Floor Plan	9
Floor Plan	10
Find your graphics dimensions	11
Graphics dimensions - section 1	12
Graphics dimensions - section 2	13
Graphics dimensions - section 3	14
Graphics dimensions - section 4	15
Graphics dimensions - section 5	16
Graphics dimensions - section 6	17
Graphics dimensions - section 7	18
Graphics dimensions - section 8	19
Graphics dimensions - section 9	20
Info	21

3D View 1



3D View 2



3D View 3



3D View 4



3D View 5



3D View 6



Floor Plan

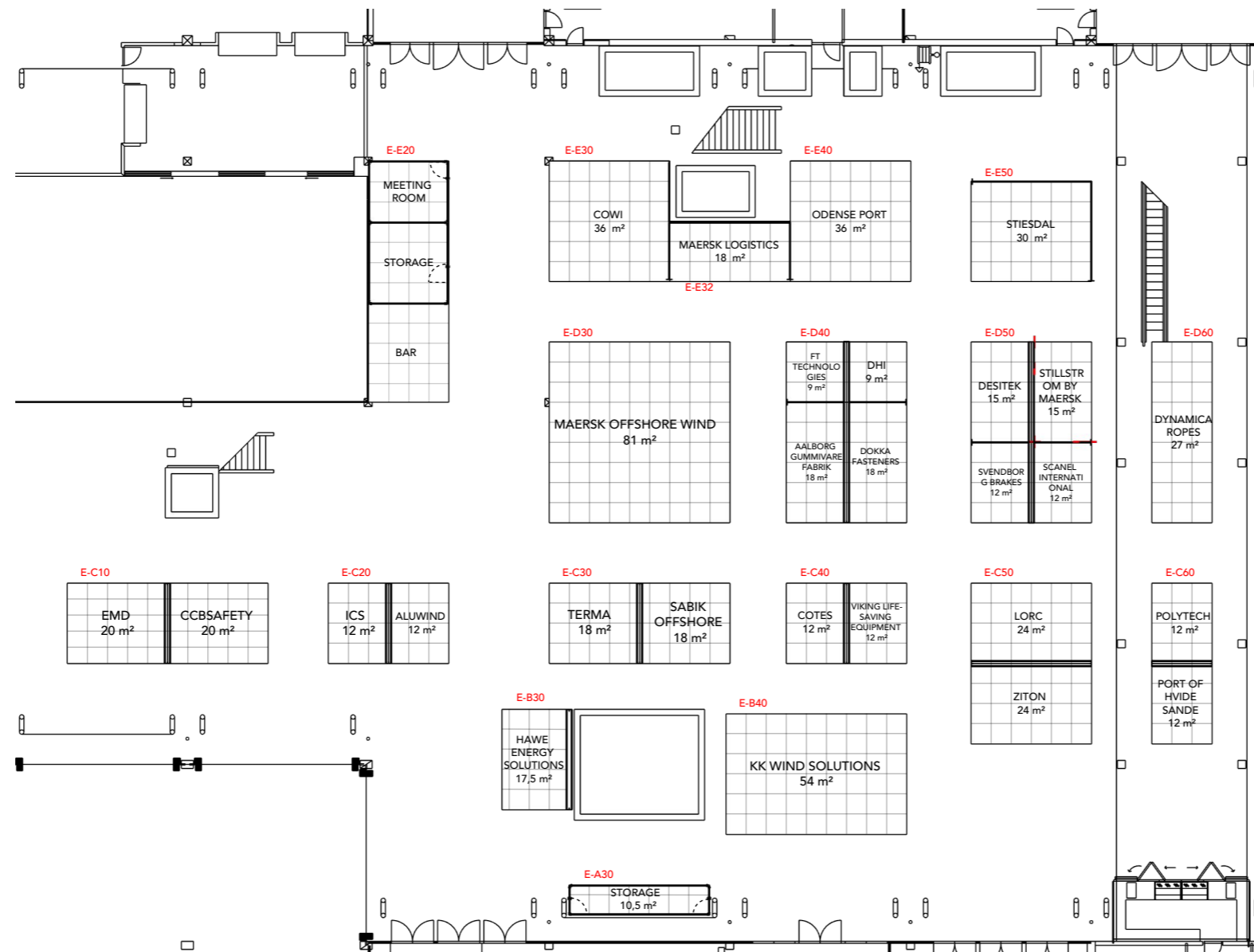

PORT OF HVIDE SANDE:
HVIDE SANDE SERVICE GROUP

Floor Plan

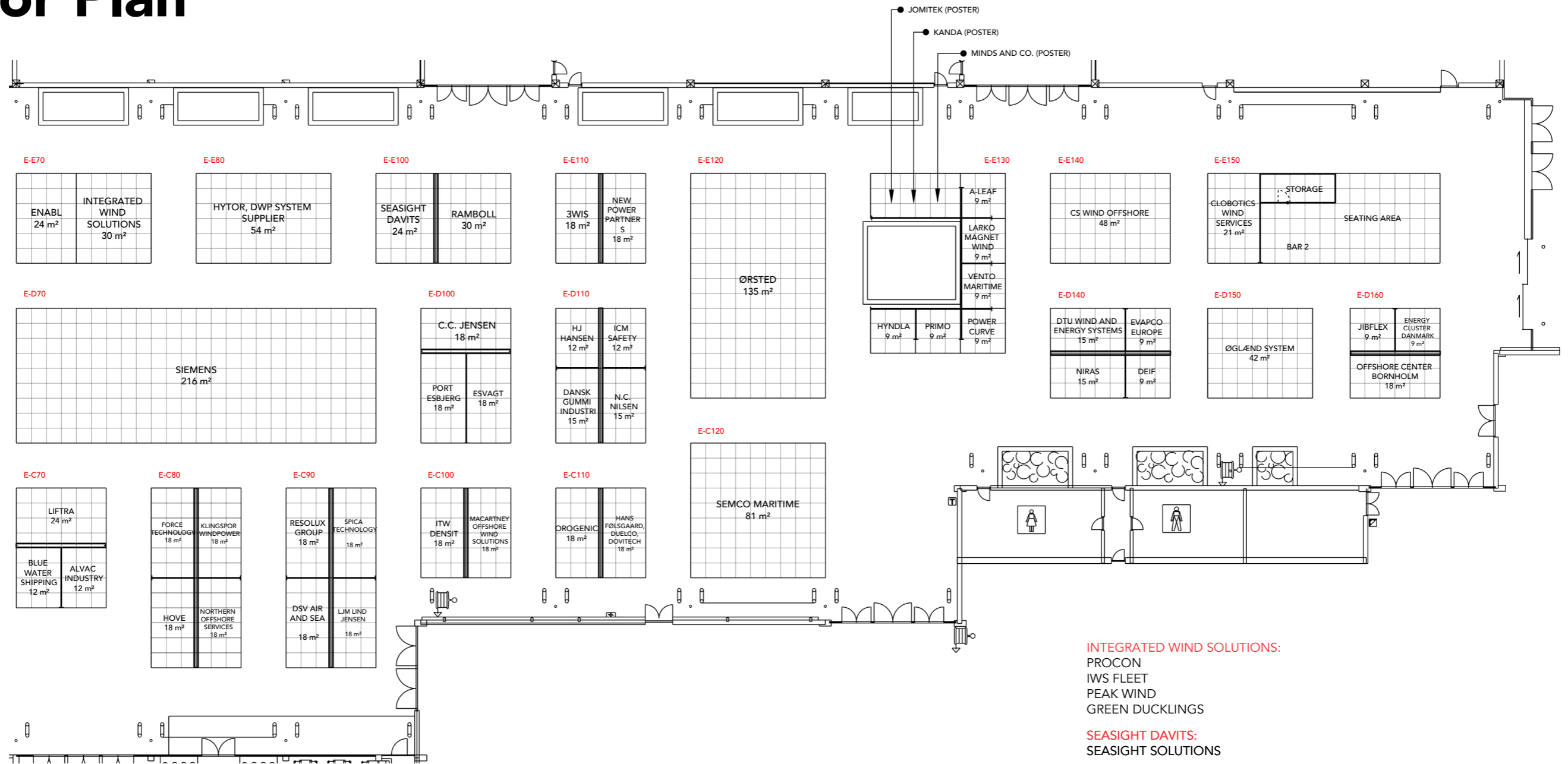

INTEGRATED WIND SOLUTIONS:

- PROCON
- IWS FLEET
- PEAK WIND
- GREEN DUCKLINGS

SEASIGHT DAVITS:

- SEASIGHT SOLUTIONS

RESOLUX GROUP:

- GEXPRO SERVICES
- FRONTIER TECHNOLOGIES

HYTOR, DWP SYSTEM SUPPLIER:

- TS TECH

Find your graphics dimensions

Page 12

ALUWIND
CCBSAFETY
EMD
HAWE ENERGY SOLUTIONS
ICS
SABIK OFFSHORE
STORAGE
TERMA

Page 14

DESITEK
SCANEL INTERNATIONAL
STIESDAL
STILLSTROM BY MAERSK
SVENDBORG BRAKES

Page 16

ALVAC INDUSTRY
BLUE WATER SHIPPING
DSV AIR AND SEA
FORCE TECHNOLOGY
HOVE
KLINGSPOR WINDPOWER
LIFTRA
LJM LIND JENSEN
NORTHERN OFFSHORE SERVICES
RESOLUX GROUP
SPICA TECHNOLOGY

Page 18

3WIS
C.C. JENSEN
DANSK GUMMI INDUSTRI
ESVAGT
HJ HANSEN
ICM SAFETY
N.C. NIELSEN
NEW POWER PARTNERS
PORT ESBJERG
RAMBOLL
SEASIGHT DAVITS

Page 20

CLOBOTICS WIND SERVICES
ENERGY CLUSTER DANMARK
JIBFLEX
OFFSHORE CENTER BORNHOLM
STORAGE

Page 13

AALBORG GUMMIVARE FABRIK
COWI
DHI
DOKKA FASTENERS
FT TECHNOLOGIES
MAERSK LOGISTICS
ODENSE PORT
STORAGE

Page 15

COTES
LORC
POLYTECH
PORT OF HVIDE SANDE
VIKING LIFESAVING EQUIPMENT
ZITON

Page 17

HANS FØLSGAARD, DUELCO, DOVITEC
ITW DENSIT
MACARTNEY OFFSHORE WIND SOLUTIONS
OROGENIC

Page 19

A-LEAF
DEIF
DTU WIND AND ENERGY SYSTEMS
EVAPCO EUROPE
HYNDLA
JOMITEK (P)
KANDA (P)
LARKO MAGNET WIND
MINDS AND CO. (P)
NIRAS
POWER CURVE
PRIMO
VENTO MARITIME

Graphics dimensions - section 5

WALL HEIGHT: 2480mm

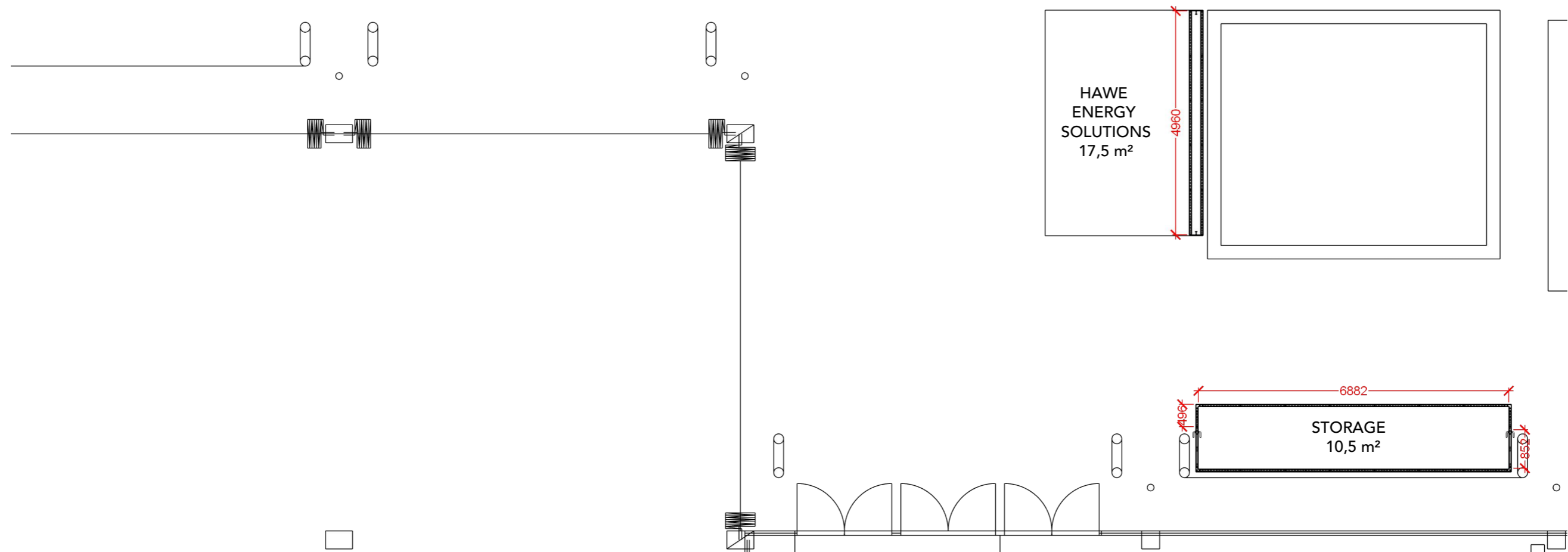
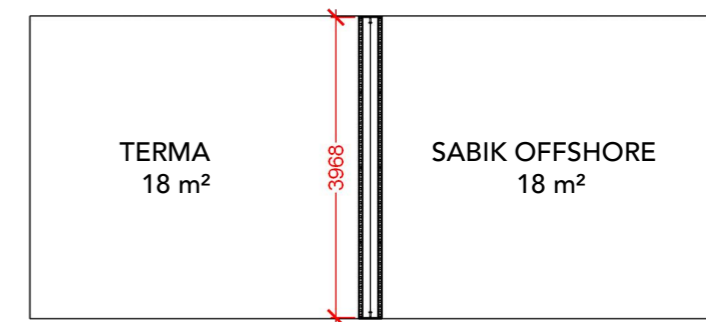
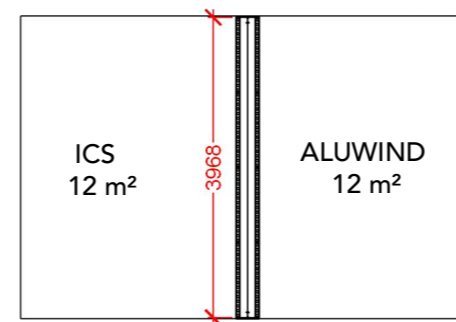
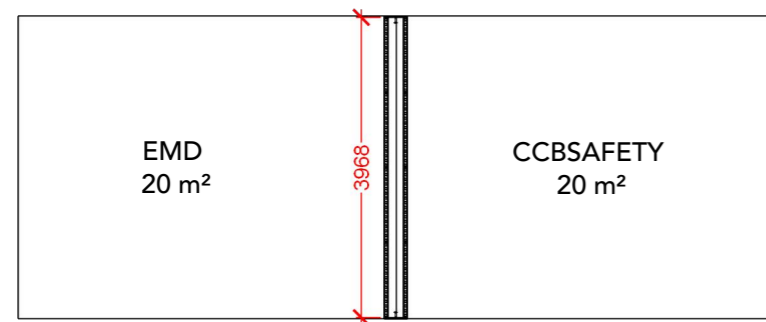

Graphics dimensions - section 2

WALL HEIGHT: 2480mm

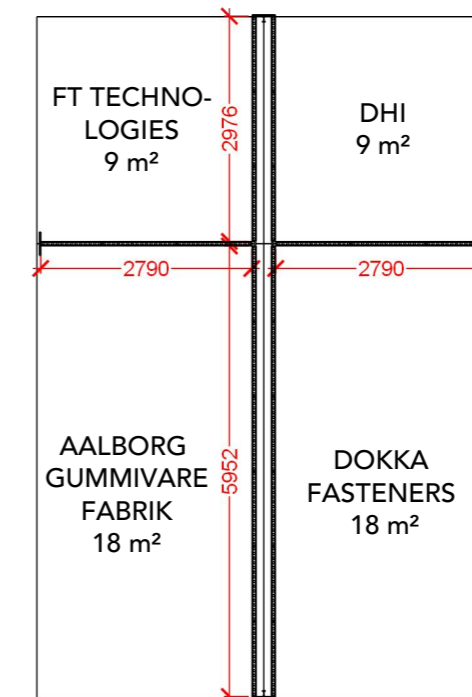
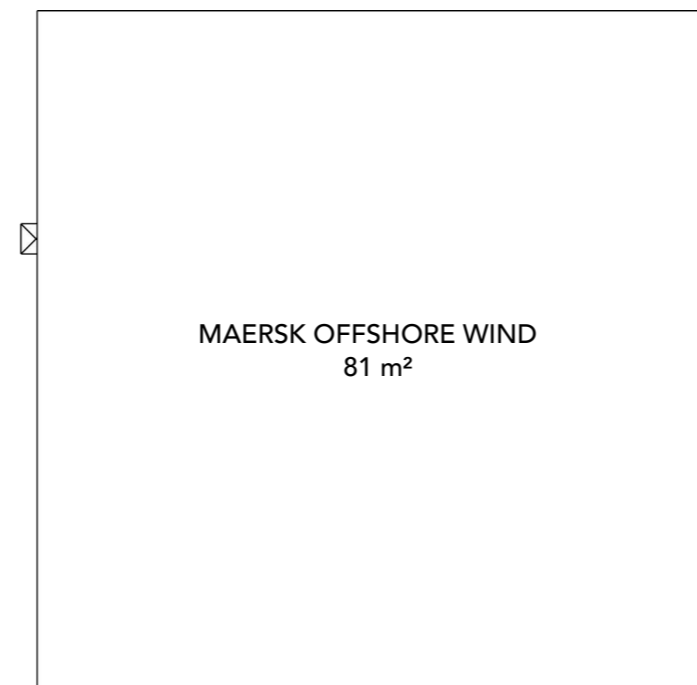
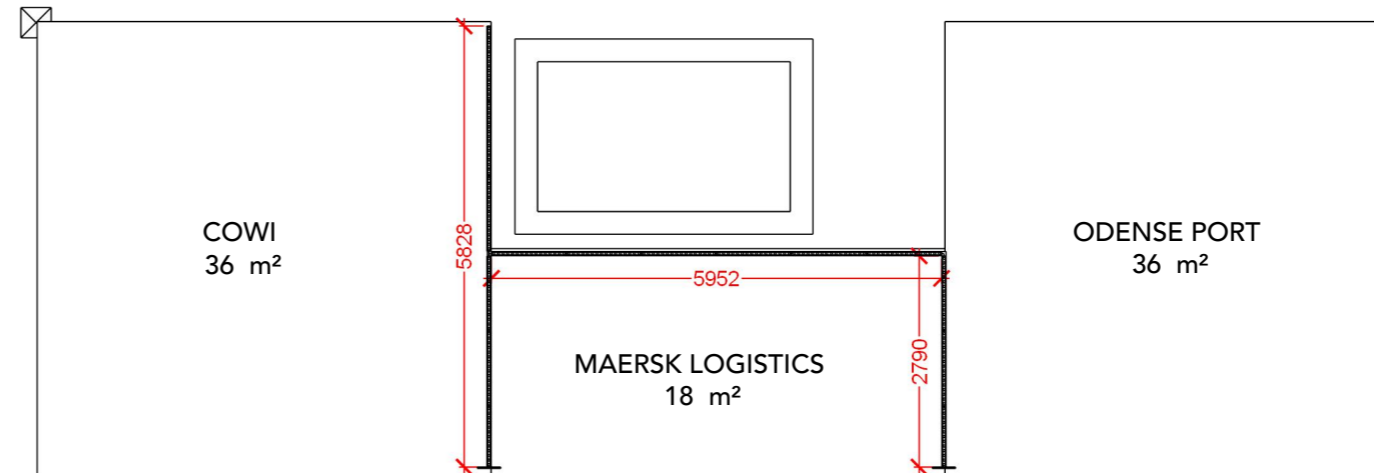
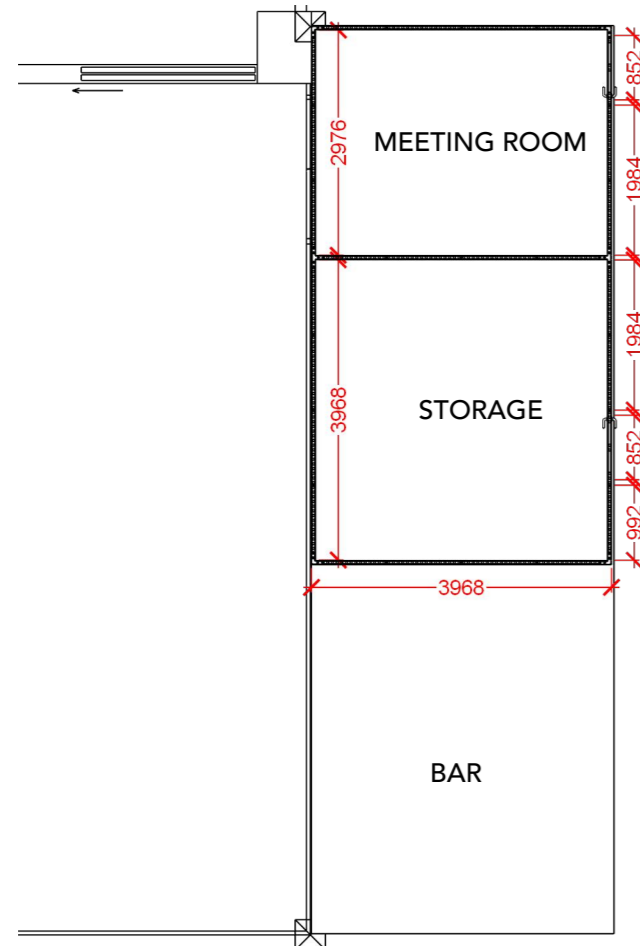

Graphics dimensions - section 3

WALL HEIGHT: 2480mm

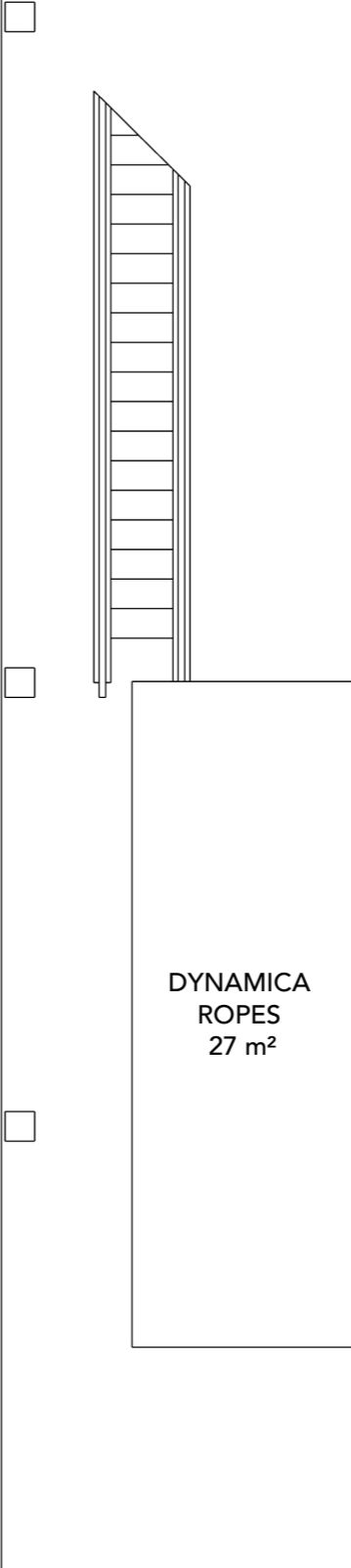
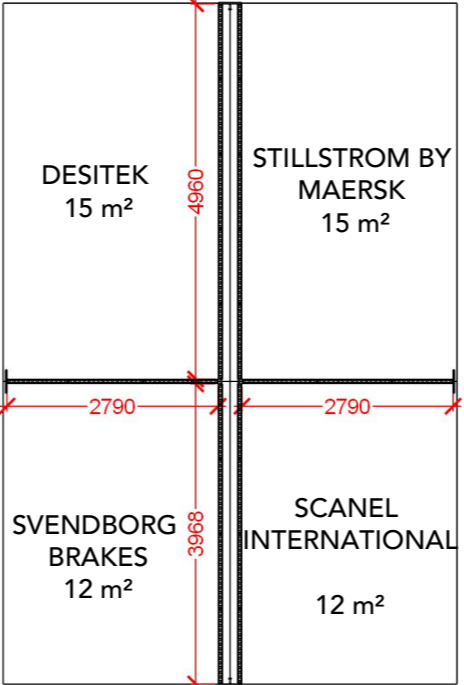
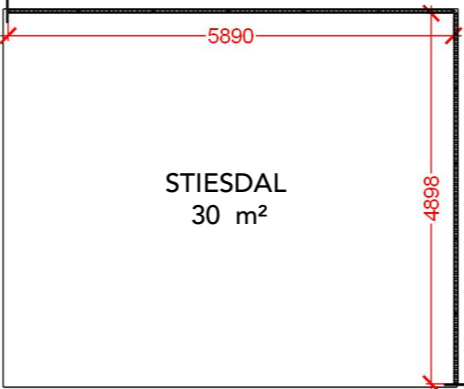

Graphics dimensions - section 4

WALL HEIGHT: 2480mm

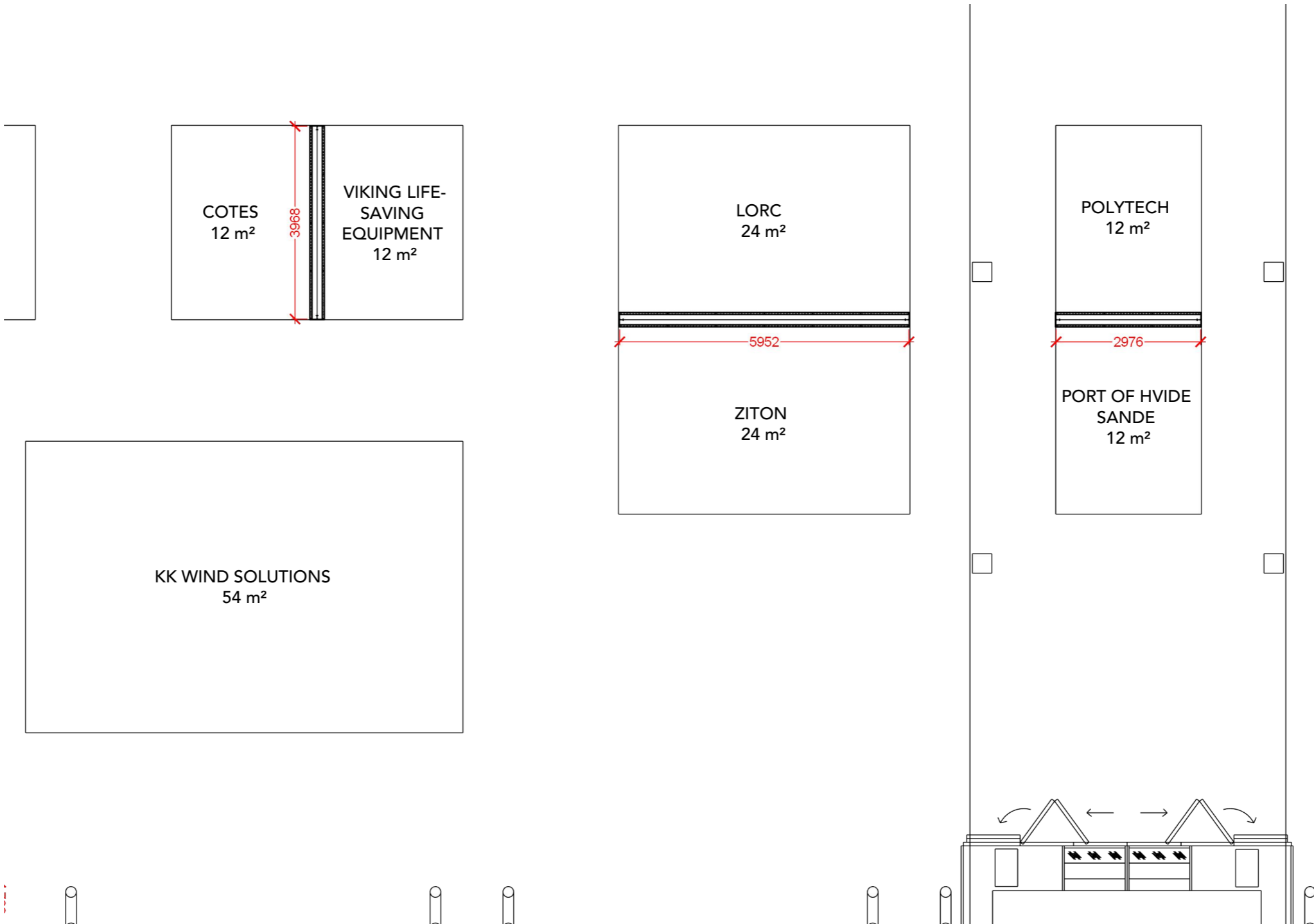

Graphics dimensions - section 5

WALL HEIGHT: 2480mm

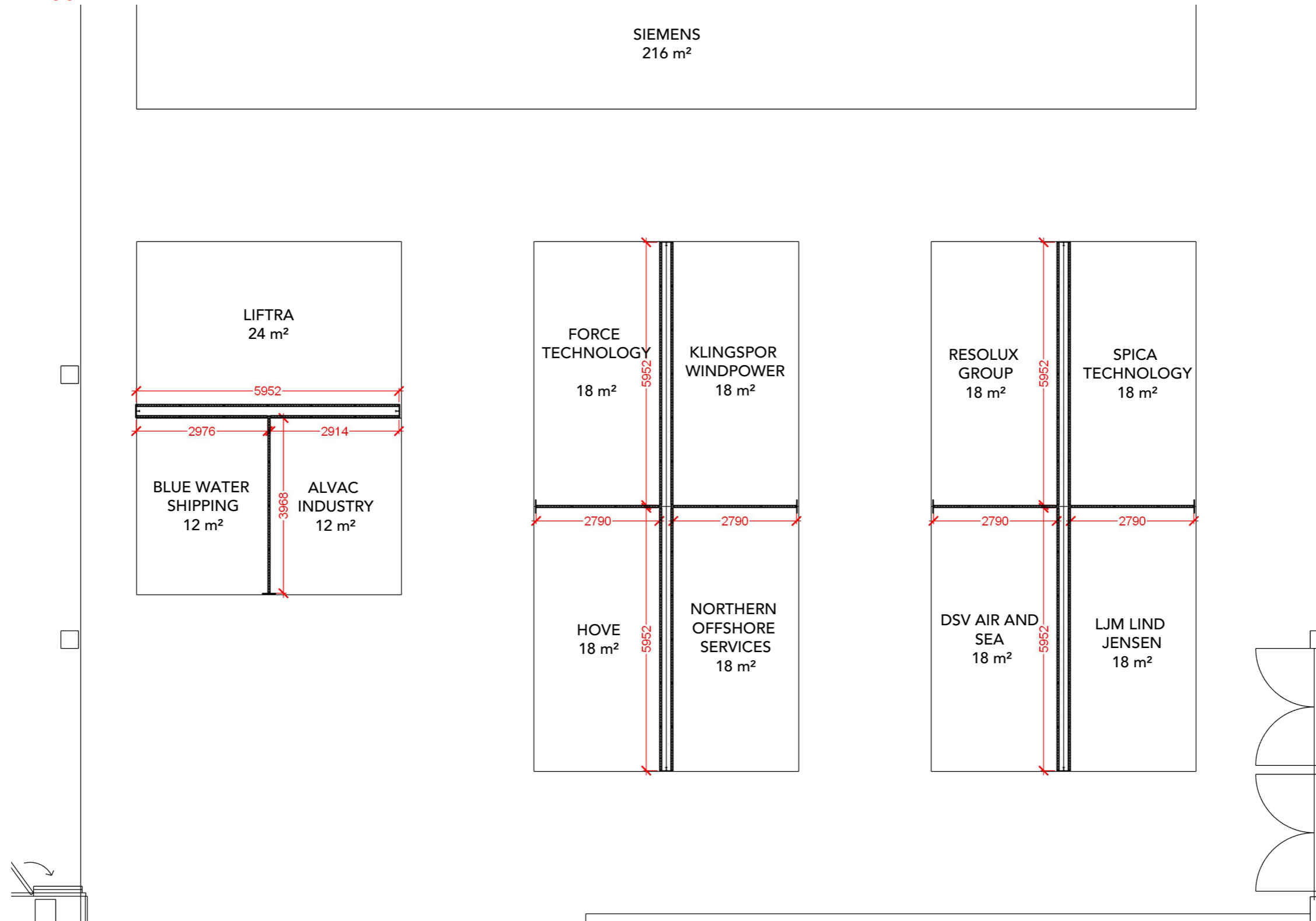

Graphics dimensions - section 6

WALL HEIGHT: 2480mm

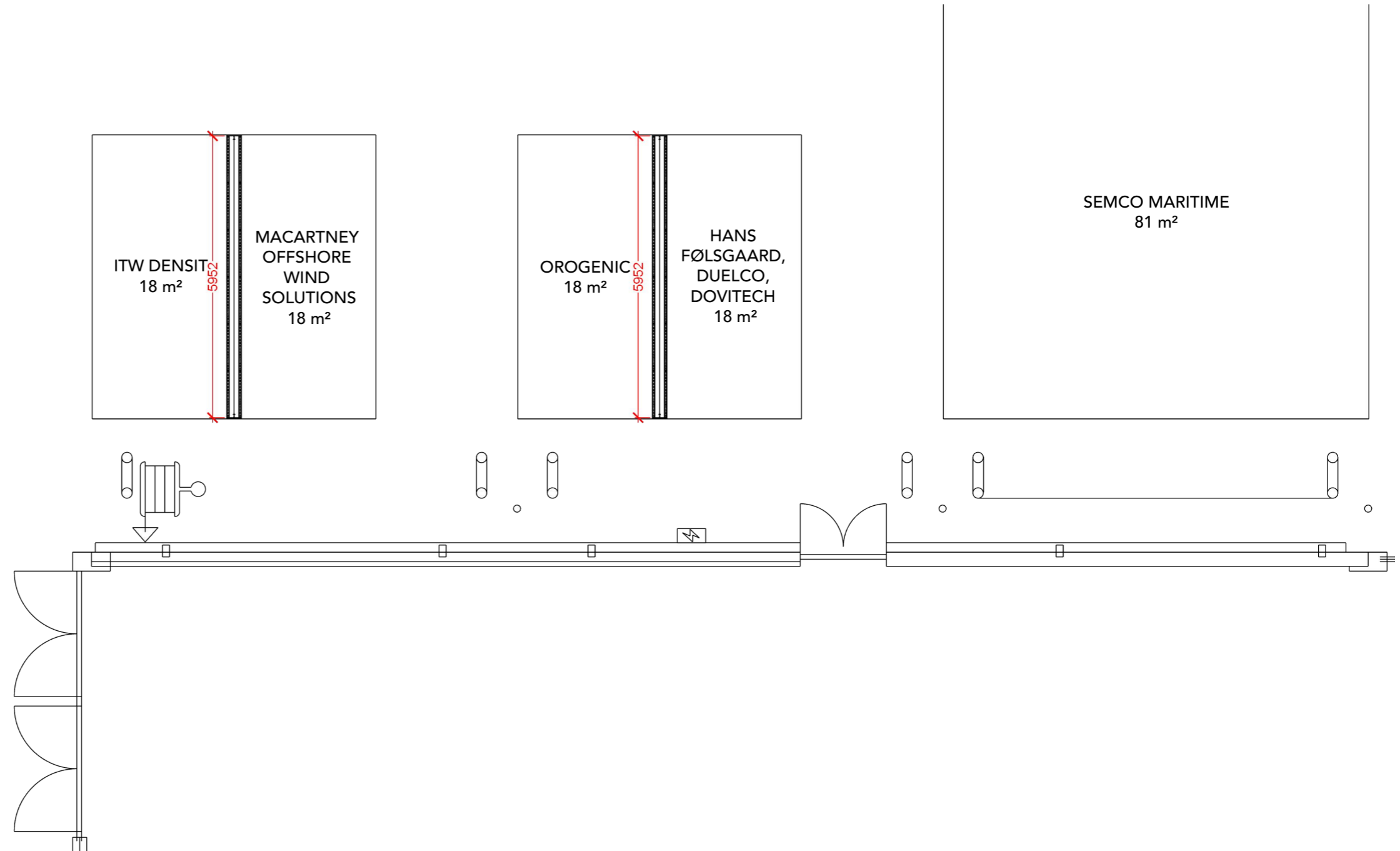

Graphics dimensions - section 7

WALL HEIGHT: 2480mm

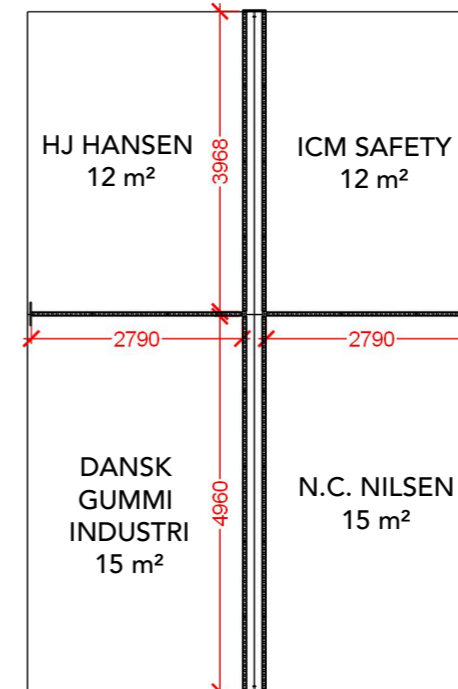
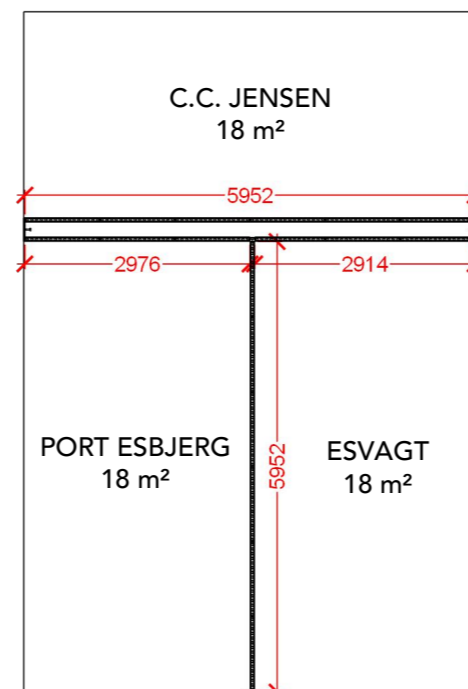
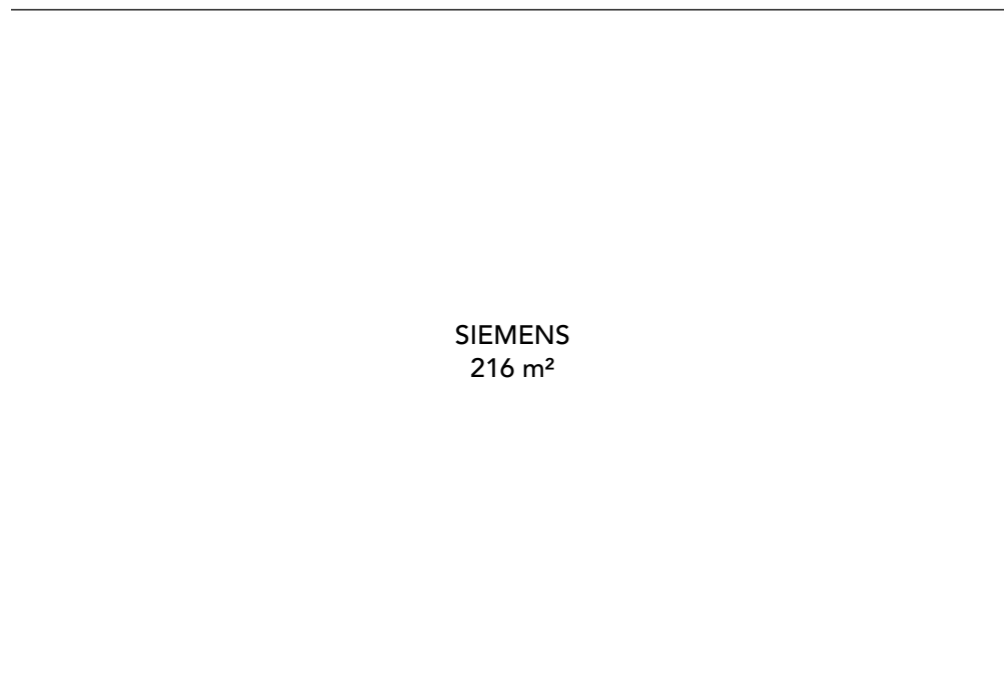
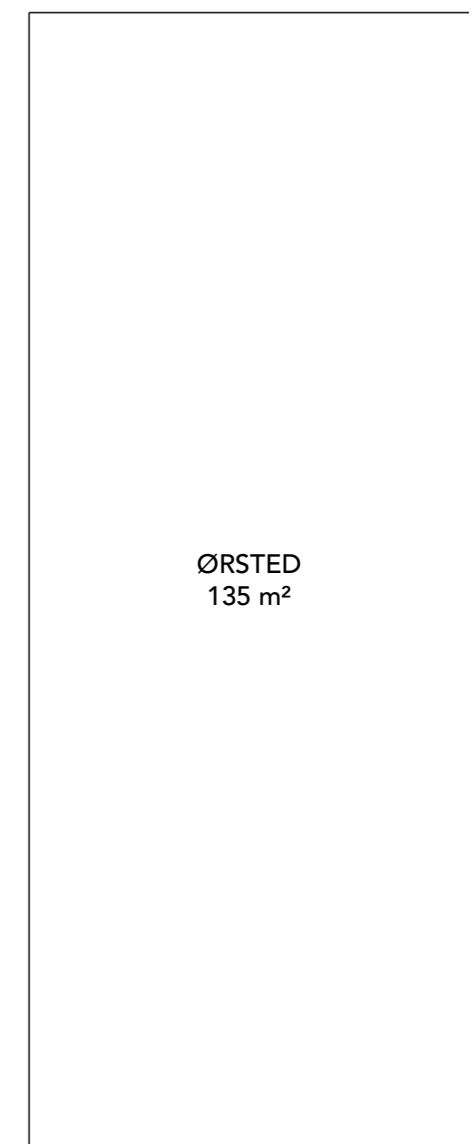
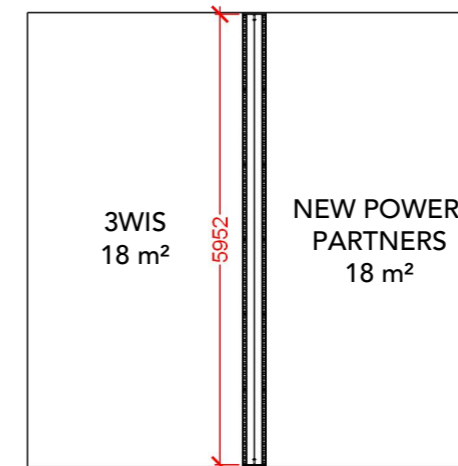
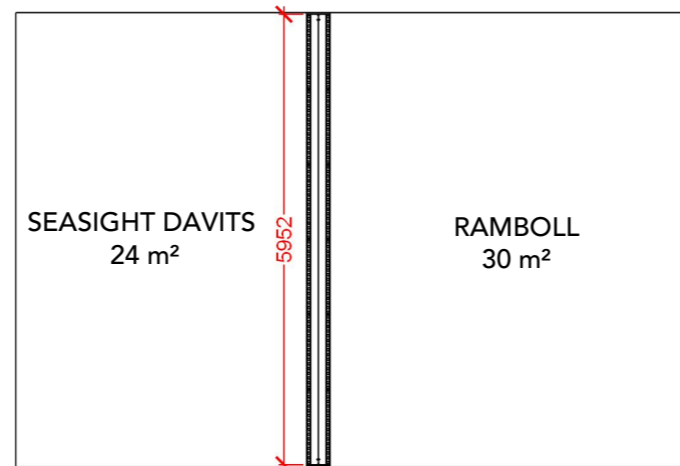
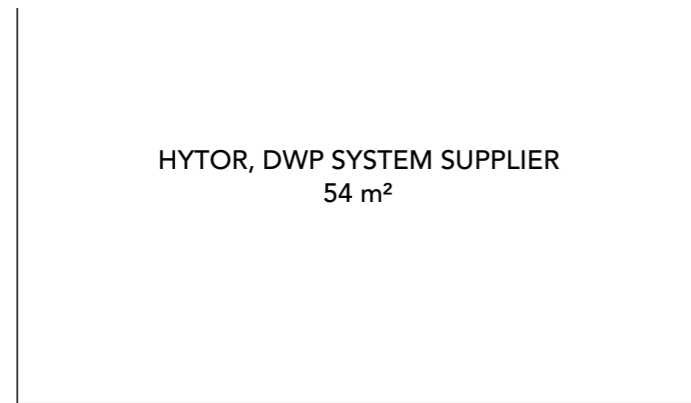

Graphics dimensions - section 8

WALL HEIGHT: 2480mm

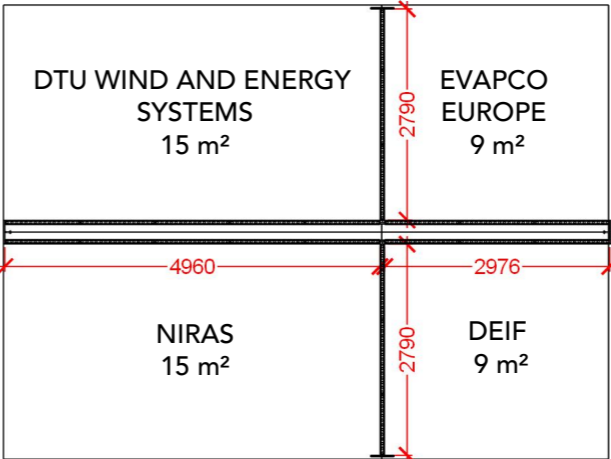
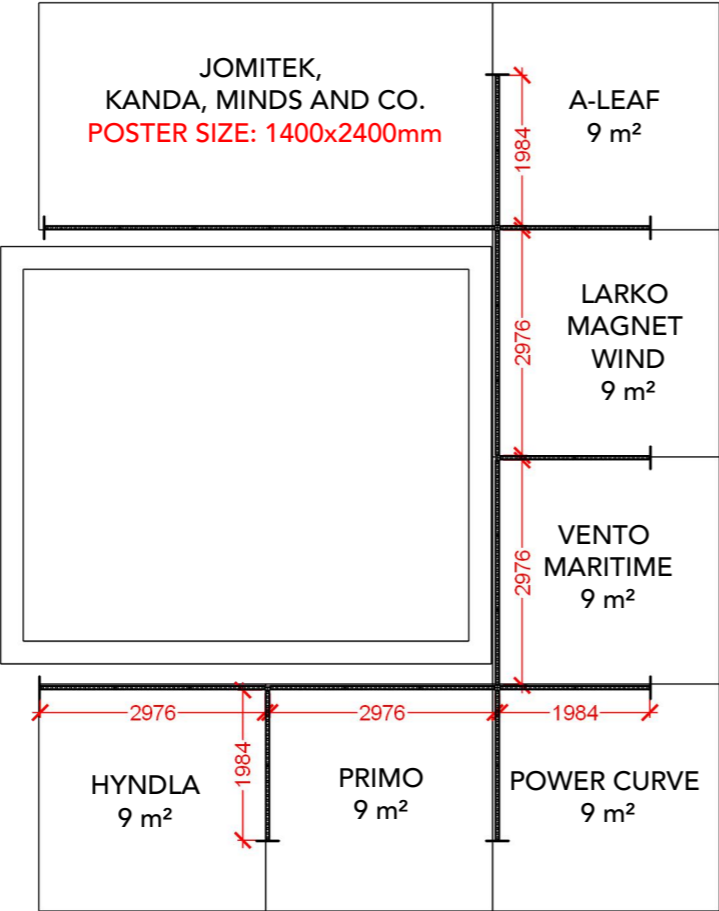

Graphics dimensions - section 9

WALL HEIGHT: 2480mm

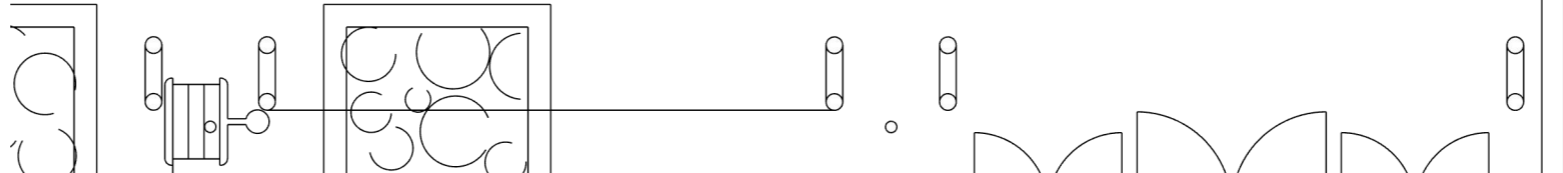
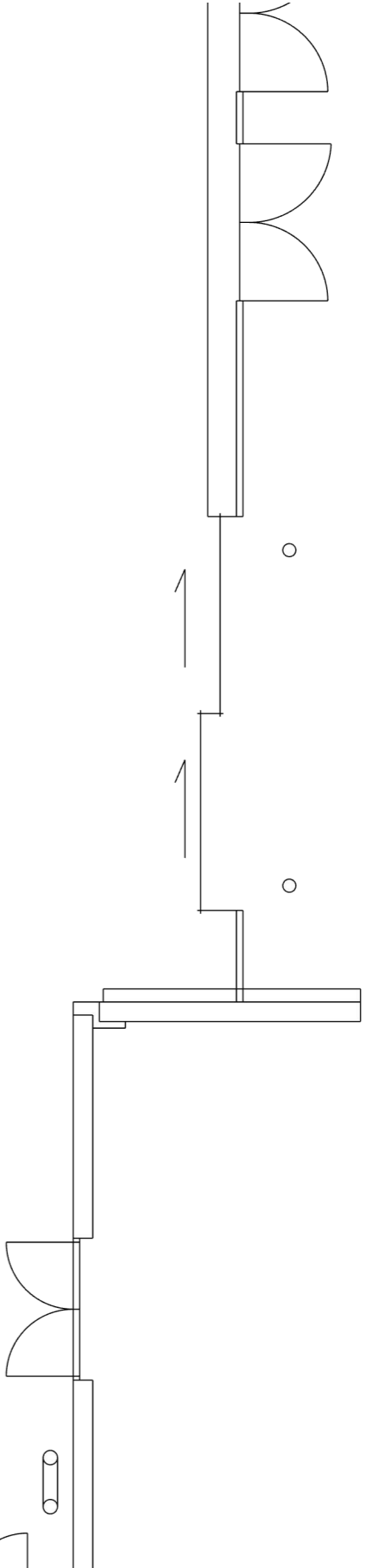
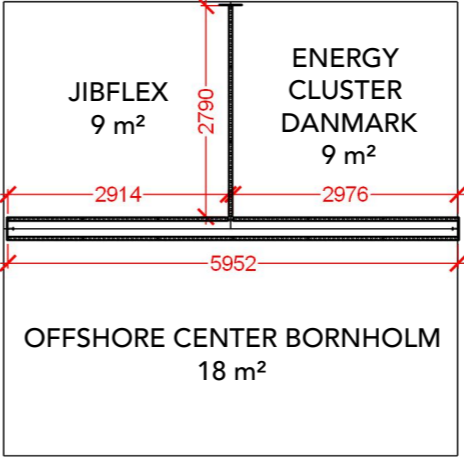
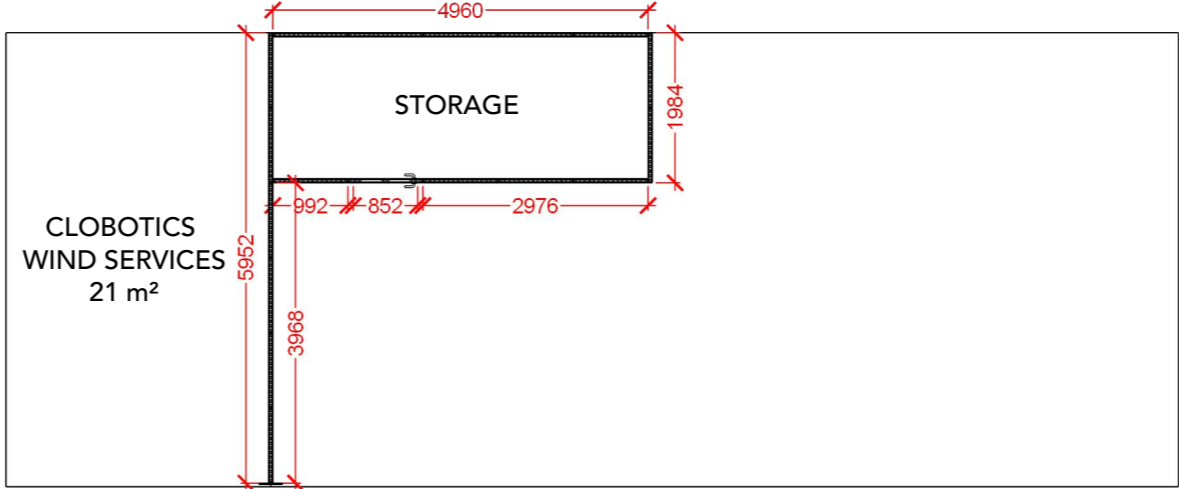

Info

Client: Danish Energy Export
Exhibition: Wind Europe 2025

Project no.: EXP-WEU-25-04
Designed By: SMM / THJ
Hall: E
Booth: Multiple

Creation Date: 13.11.2024
Revision Date: 05.12.2024
Revision no.: 03

Comments:

The drawing is indicative and without responsibility. The drawing is NOT to scale. The stand-builder will have the final call in all decisions regarding stability and security. Some products are only shown to indicate locations, but not the actual product as this product may be changed.
All design is subject to copyright by Compass Fairs A/S and Standesign A/S

